

Quick Start Guide
45-0643 Weed Eliminator

Read the manual that came with your Push Spreader for:

- Important safety warnings
- Further explanation of features
- Operating instructions and flow control adjustments

Problem?
Call 1-800-448-9282



Quick Start Guide
45-0643 Weed Eliminator

Read the manual that came with your Push Spreader for:

- Important safety warnings
- Further explanation of features
- Operating instructions and flow control adjustments

Problem?
Call 1-800-448-9282



HARDWARE PACKAGE

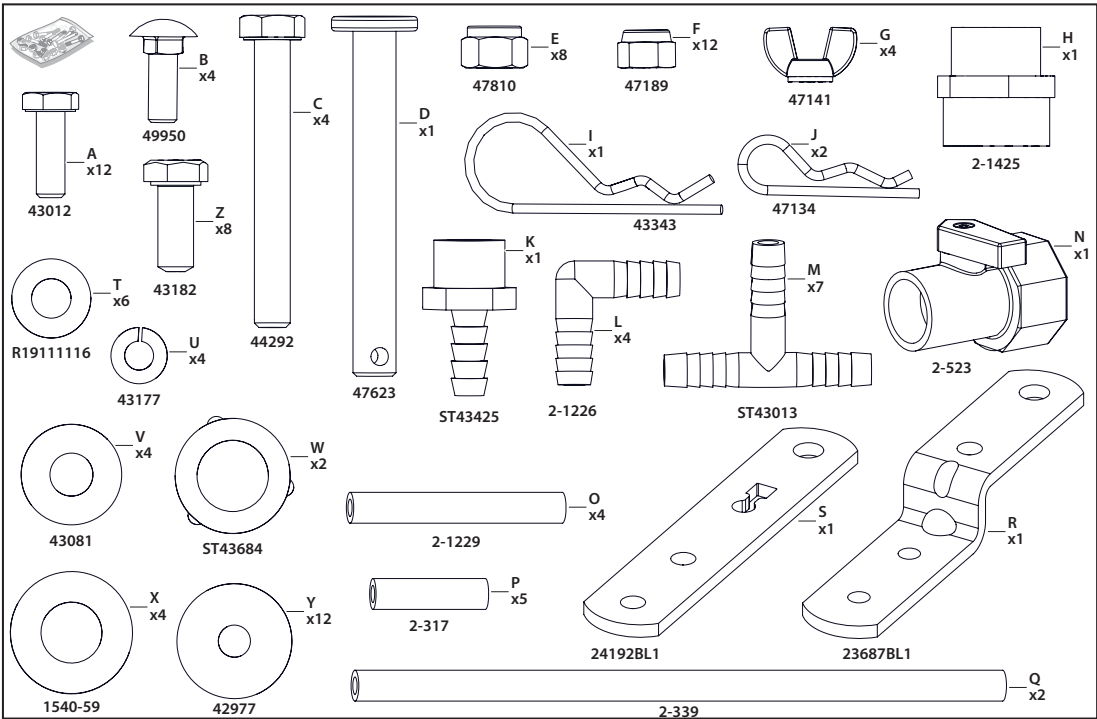

PARTS NOT SHOWN IN FULL SIZE

CARTON CONTENT

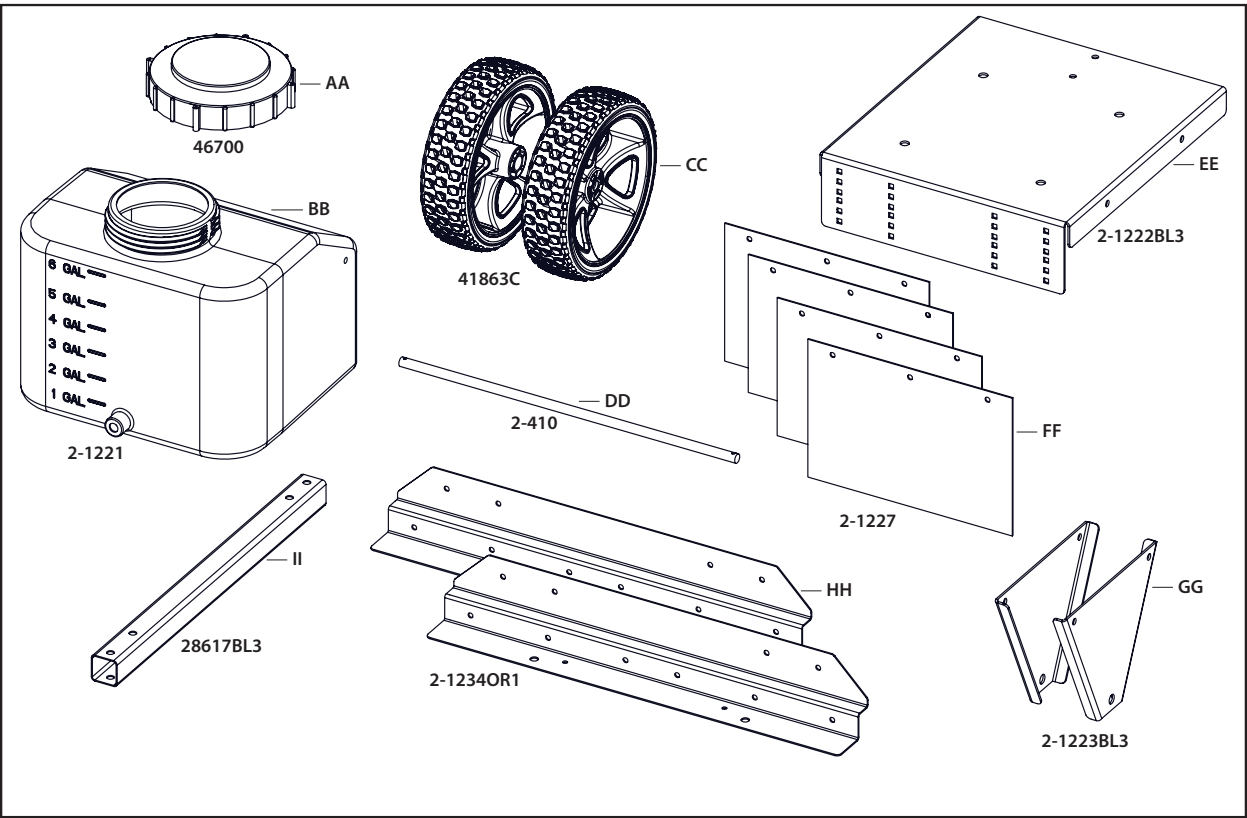

PARTS NOT SHOWN IN FULL SIZE

Assembly Step 1

1. Attach the wheel support bracket (GG) to the inside of the tank mount frame (EE). Using two 5/16" x 3/4" hex bolts (Z) and 5/16" nylock nuts (E).
2. Repeat on the other side.
3. Tighten hardware.

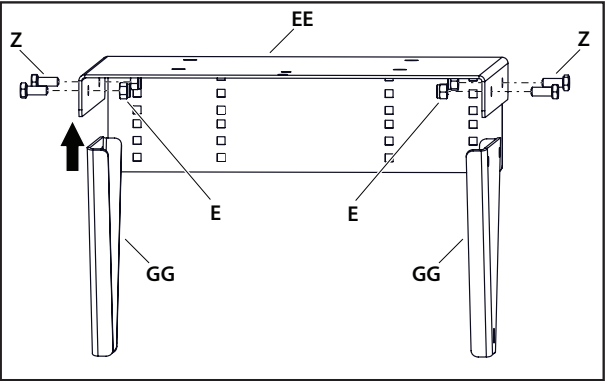

Assembly Step 2

1. Slide the 1/2" axle (DD) through the wheel support brackets (GG).

Note: Center the axle with the frame.

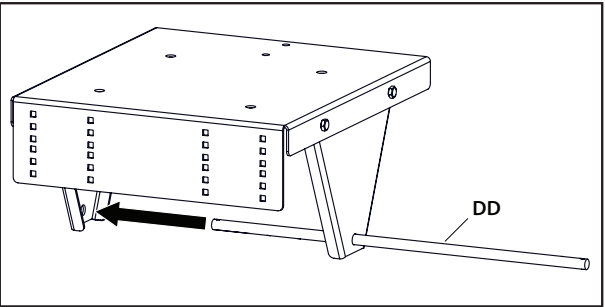

Assembly Step 3

1. Install a 1-1/16" washer (X), wheel & tire assembly (CC), and another 1-1/16" washer (X) onto the axle (DD).
2. Secure with a hair cotter pin (J) onto the axle (DD).
3. Repeat on the other side.

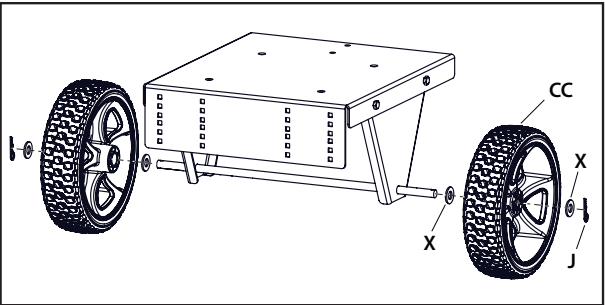

Assembly Step 4

1. Place the tank (BB) onto the frame (EE) as shown in image below.
 2. Assemble four 11/16" washers (T) onto four 5/16" x 3/4" bolts (Z).
 3. Install the four bolts through the bottom of the frame (EE) and into the tank (BB) bottom.
 4. Tighten hardware.
- Note: Do not overtighten the hardware.
5. Screw on the tank lid (AA) to the tank (BB).

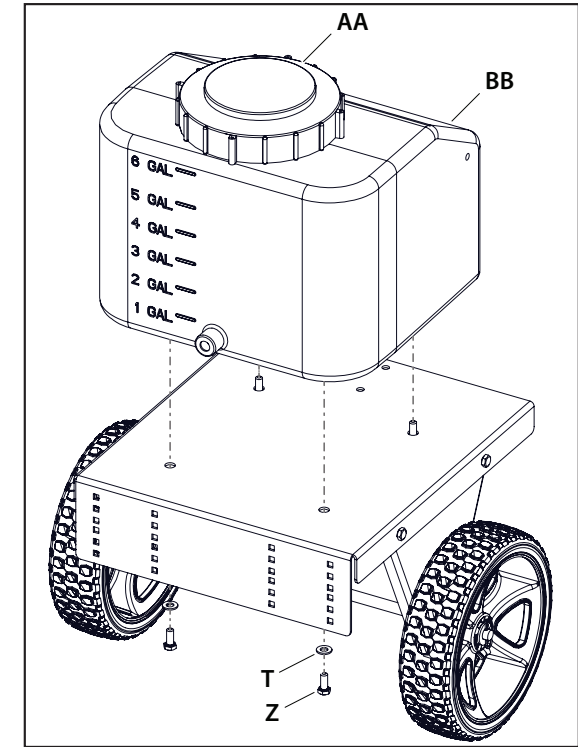

Assembly Step 5

1. Attach the drawbar (II) to the frame (EE). (Drawbar will go under the frame) Install two 5/16" x 2-1/2" hex bolts (C) through the frame (EE) and drawbar (II).
2. Install a 11/16" washer (T) and a 5/16" nylock nut (E) onto both bolts (C).
3. Tighten hardware.
4. Install two 5/16" x 2-1/2" hex bolts (C) through the hitch bracket (R), straight hitch bracket (S), and drawbar (II).
5. Secure bolts with two 5/16" nylock nuts (E). Tighten hardware.
6. Install the hitch pin (D) through both hitch brackets.
7. Secure with a 2-5/16" hair cotter pin (I).

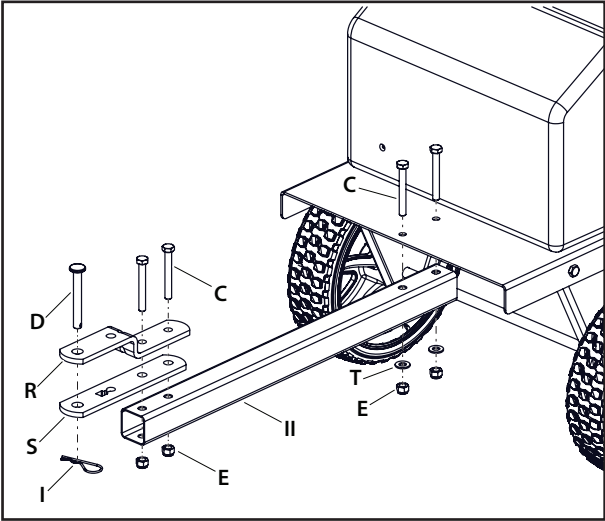

Quick Start Guide

45-0643 Weed Eliminator

Read the manual that came with your Push Spreader for:

- Important safety warnings
- Further explanation of features
- Operating instructions and flow control adjustments

Problem?
Call 1-800-448-9282



Quick Start Guide

45-0643 Weed Eliminator

Read the manual that came with your Push Spreader for:

- Important safety warnings
- Further explanation of features
- Operating instructions and flow control adjustments

Problem?
Call 1-800-448-9282



Assembly Step 6

1. Orientate the boom bracket (HH) as shown in image below.
2. Install a 1/4" x 3/4" hex bolt (A) through the boom bracket (HH) and a felt pad (FF). Make sure the holes on the felt pad (FF) are at the top as shown in image below).
3. Secure bolt (A) with a 1" washer (Y) and a 1/4" nylock nut (F).
4. Install the other two bolt assemblies to secure the felt pad (FF) to the boom bracket (HH)
5. Tighten hardware.
6. Repeat the steps for the other three felt pads (FF).

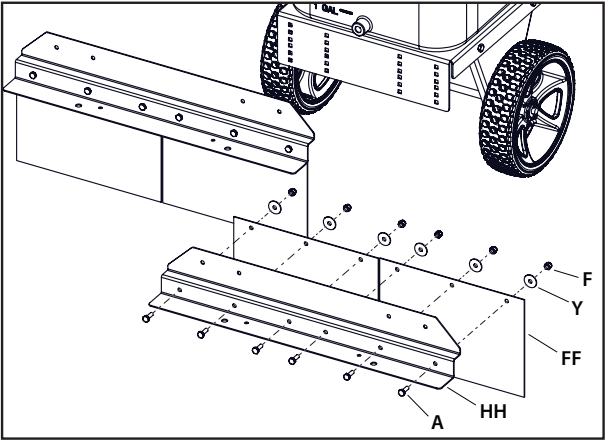

Assembly Step 7

1. Install two 1/4" x 3/4" carriage bolts (B) through the bottom two right holes on the tank frame. Threads will be facing the rear of the unit as shown in image below.
2. Install two 7/8" washers (V) onto the carriage bolts (B).
3. Install the boom bracket onto the bolts and then a 1/4" lock washer (U) on each bolt (B).
4. Install and tighten the two nylon wing nuts (G) onto the two bolts (B).
5. Repeat steps for the other boom bracket.

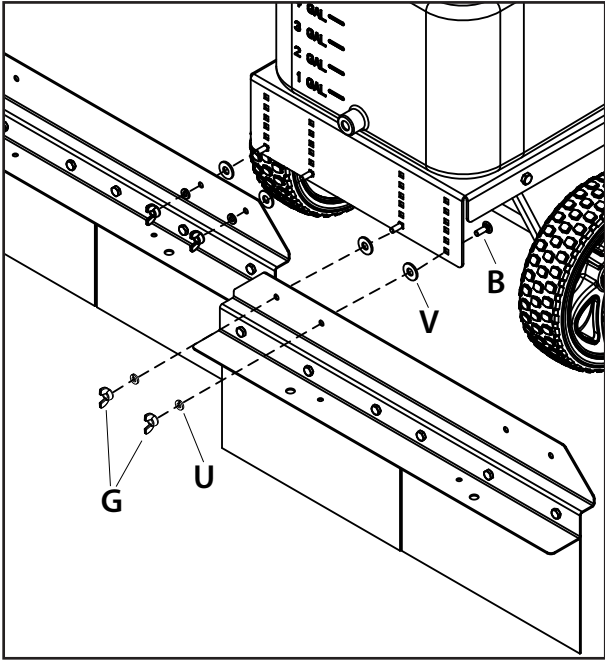

Make sure there is a slight curve in the felt after boom installation. If not adjust the boom height.

Assurez-vous qu'il y a une légère courbure dans le feutre après l'installation de la flèche. Sinon, ajustez la hauteur de la flèche.

Asegúrese de que haya una ligera curva en el fieltro después de la instalación de la pluma. Si no es así, ajuste la altura de la pluma.

Assembly Step 8

1. Assemble four 3/8" x 2-1/2" hoses (P) onto the four 3/8" tee barbs (M). (Use fitting location one). See image below.
2. Assemble a 3/8" x 4-3/4" hose (O) onto a elbow fitting (L). (Short end of elbow fitting (L) will face down.) Repeat for the other three elbows. See image below.
3. Assemble a elbow/hose assembly onto each end of a 3/8" tee barb (M). (Use fitting location two and three). Repeat step again.
4. Install the elbows into the boom bracket (HH). See image below.
5. Assemble the t-fitting/hose assembly onto the other end of the elbows. See image below.

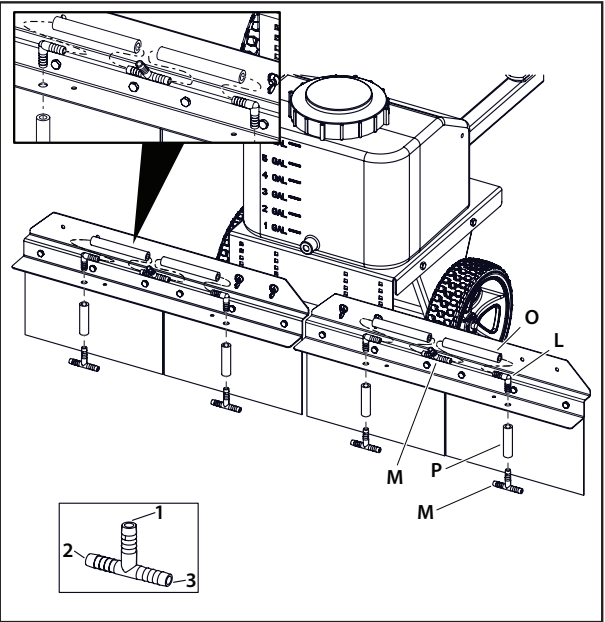

Assembly Step 9

1. Install a vinyl washer (W) and 3/4" valve fitting (N) onto the drain fitting on the tank. Make sure the valve is facing up.
2. Install a vinyl washer (W) and 3/4" coupler fitting (H) onto the valve fitting (N).
3. Install the 1/2" MP x 3/8" barb fitting (K) onto the coupler fitting (H). See image below.
4. Install a 3/8" x 2-1/2" hose (P) onto the barb fitting (K).
5. Install the 3/8" tee barb (M) into the other end of the hose (P) as show in image below.
6. Install a 3/8" x 14-1/2" hose (Q) onto each end of the 3/8" tee barb (M) just installed.
7. Attach the open end of each hose (Q) into the t-fitting (M) installed in Step 8.

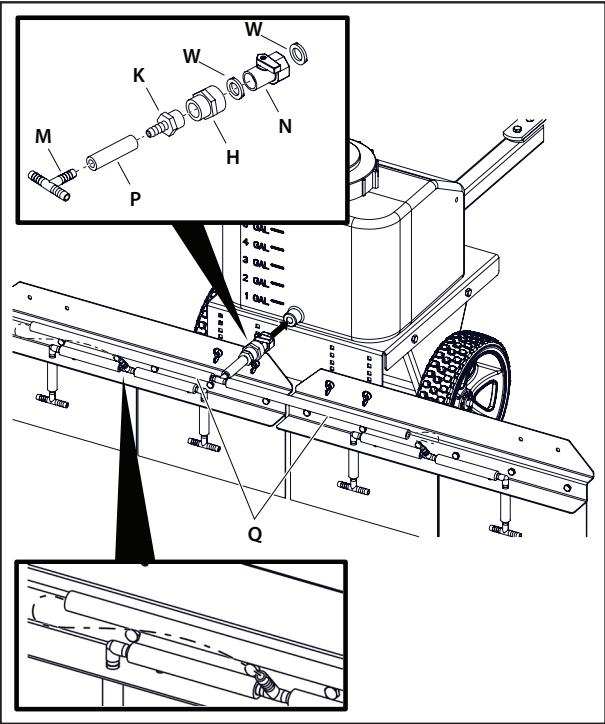

SAFETY

1. Read this owners manual and the vehicle owners manual before using this sprayer.
2. Never allow children to operate this sprayer.
3. Do not allow anyone to ride on or sit on this sprayer.
4. Keep the area clear of all persons, especially small children.
5. Read the chemical label before handling or mixing chemicals.
6. Wear eye and hand protection and protective clothing when handling and applying lawn chemicals.
7. Liquid spray material is recommended. Sprayer does not agitate wettable powders.
8. Stop sprayer when tank is empty.