

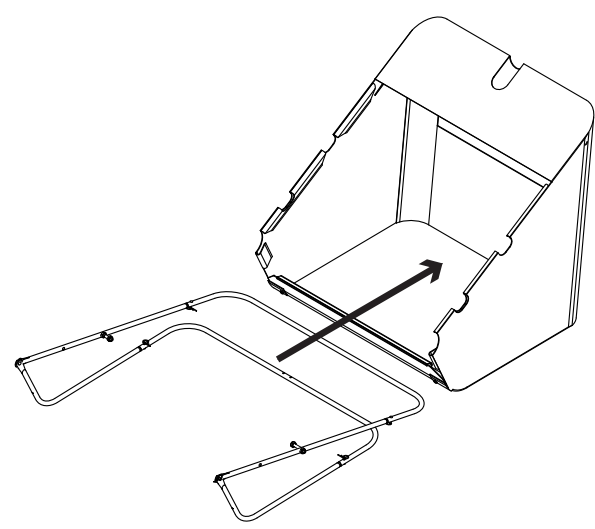

Assembly Step 9

1. Slide the bag frame into the hopper bag (10).



Assembly Step 11

1. Insert the hopper support rods (3) into the holes of the upper hopper tube. Then, flex and insert the rods into the holes in the bottom rear hopper tubes.

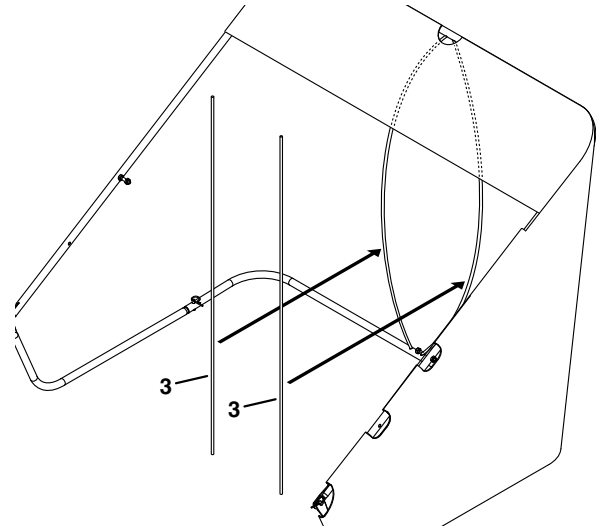

Assembly Step 13

1. Starting from the bottom of the bag, secure the hopper bag to the sides of the bag frame using the velcro straps (2, 3, 4 and 5). Secure the bag to the top of the hopper frame using the tie straps (6). Snap the sides of the hopper bag to the bottom of the hopper bag at the front corners (1).

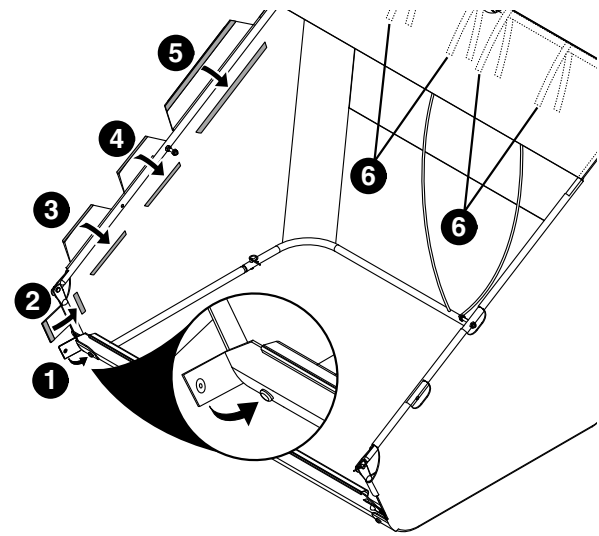

Assembly Step 15

1. Attach the upper handle tube to the rear hopper tube using a U-clamp (35), 5/16 x 1-1/4" clevis pin (22), and hair cotter pin (26).

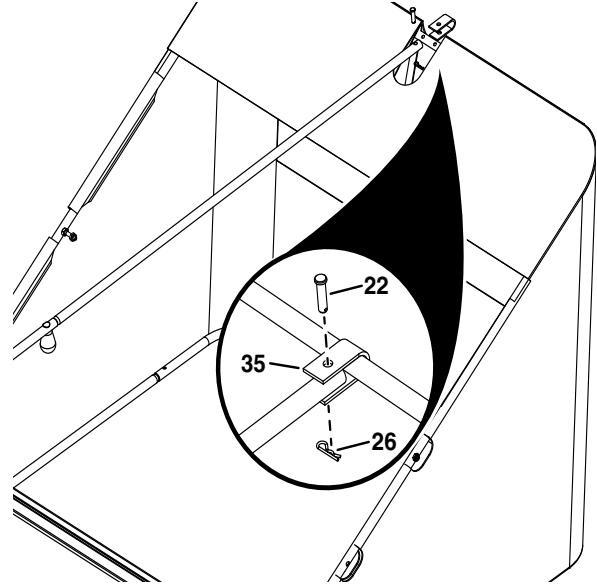

Assembly Step 17

1. Measure the height of your tractor's hitch.

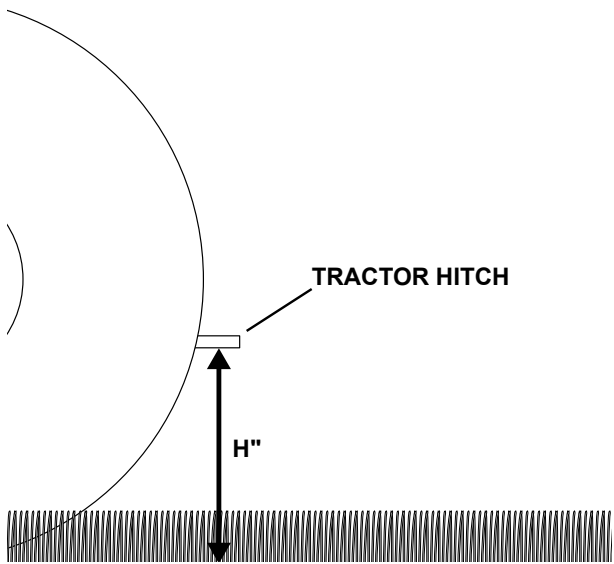

Assembly Step 10

1. Slide the bag frame tube (4) through the front flap of the hopper bag.

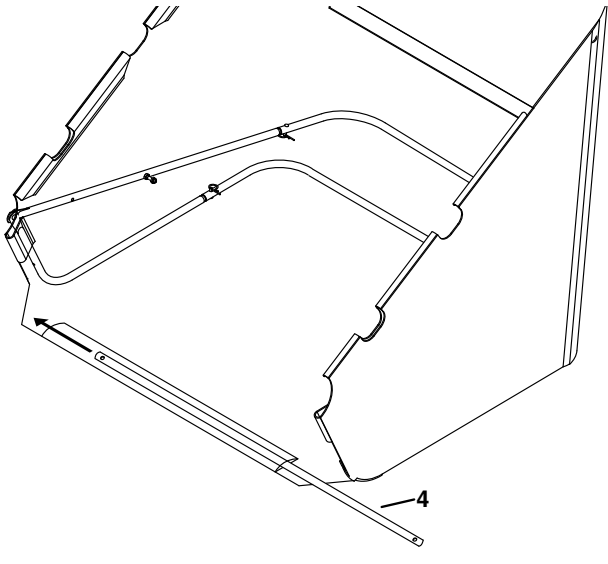

Assembly Step 12

1. Secure the bag frame tube to the lower hopper tubes using two 1/4 x 15/16" clevis pins (21) and 3/32" hair pins (20)

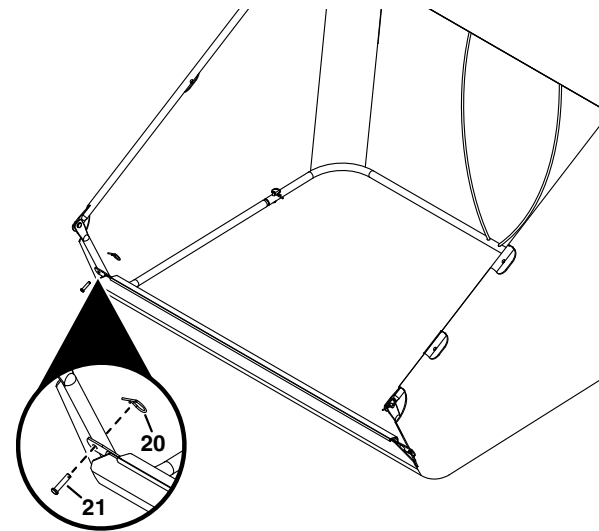

Assembly Step 14

1. Assemble the upper handle tube (11) to the lower handle tube (9) using a 1/4 x 1" bolt (19) and knob (36). Then, assemble the handle grip (33) to the lower handle tube (9).

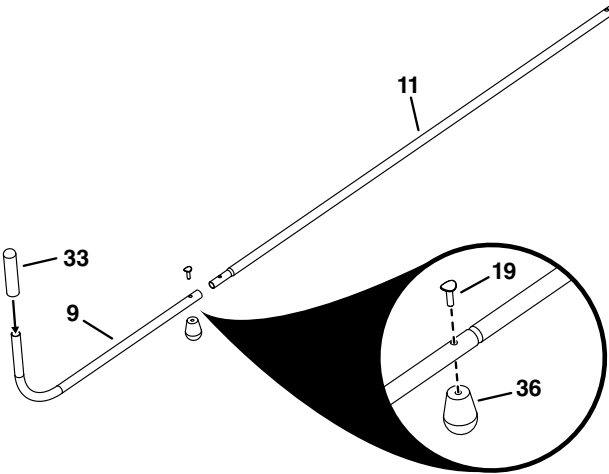

Assembly Step 16

1. Insert the bolts on the sweeper bag into the bag arms.

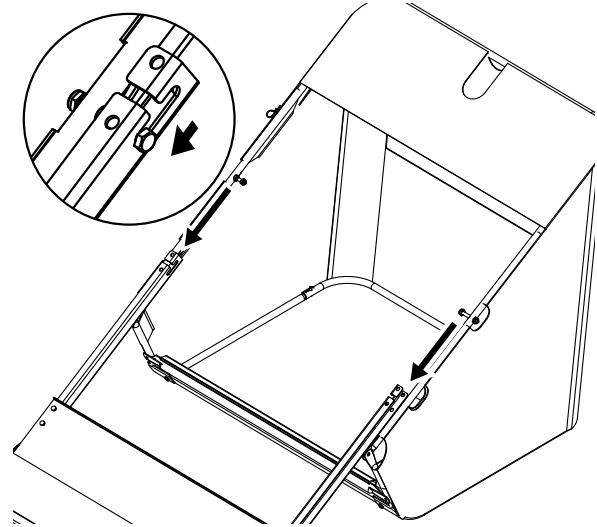

Assembly Step 18

1. Arrange the hitch brackets (6,7) according to the height of your tractor's hitch. Assemble the hitch brackets to the drawbar using two 5/16" x 2-1/2" hex bolts (29) and 5/16" nylock nuts (28).
2. Assemble the hitch pin (34), the two spacers (38), and the 3/32" x 2-5/16" hair cotter pin (27) to the hitch brackets.

