

HARDWARE PACKAGE

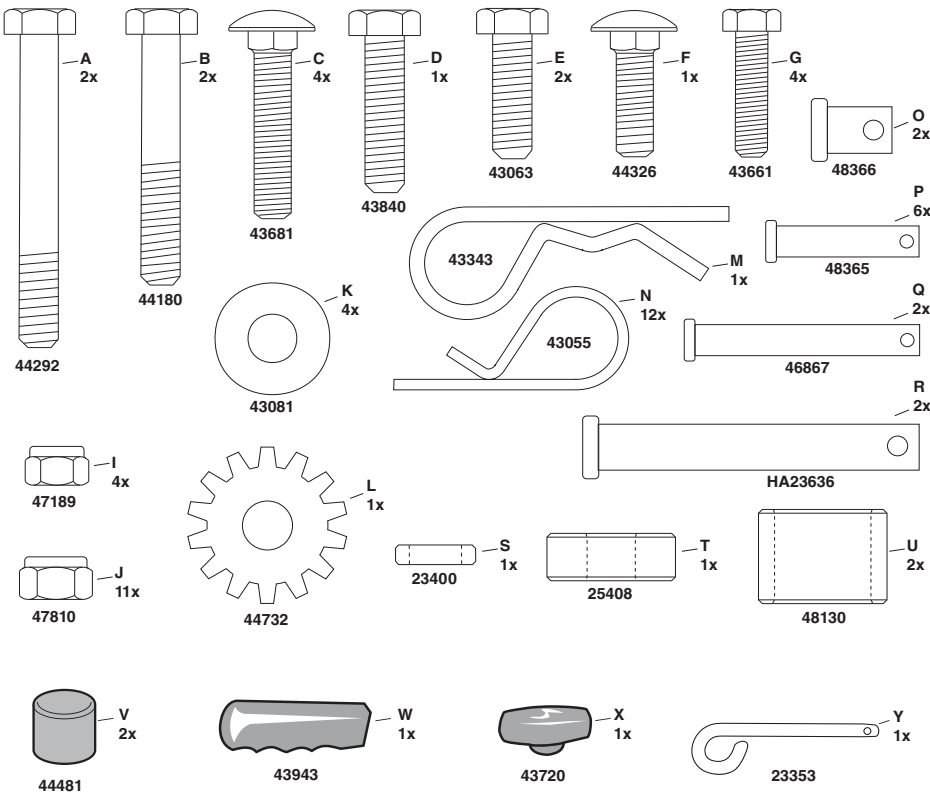

STEP 1: (SEE FIGURE 1)

- Locate the brushes (1) and identify the brush retainer marked red (2) and black (3).

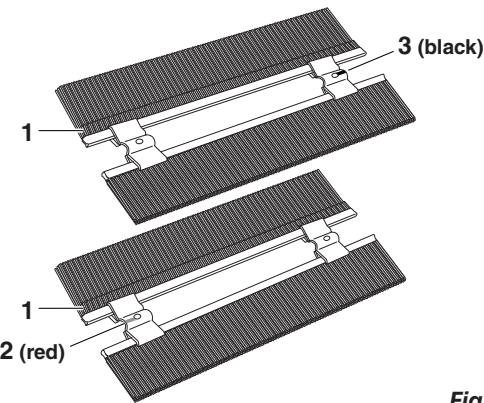

Figure 1

STEP 2: (SEE FIGURE 2)

- Turn the sweeper body upside down.

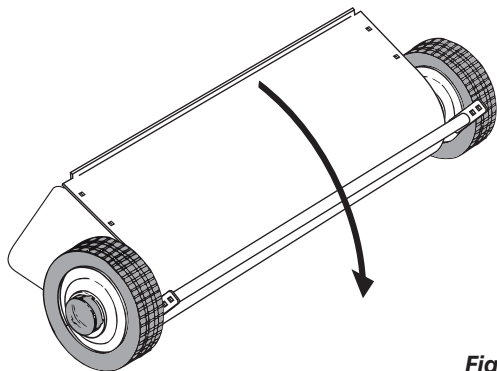

Figure 2

STEP 3: (SEE FIGURE 3)

- Install the brush with retainer marked red (2) onto the brush shaft and secure in place with a 1/4-20 x 1" hex bolt (G) and 1/4-20 nylock nut (I).

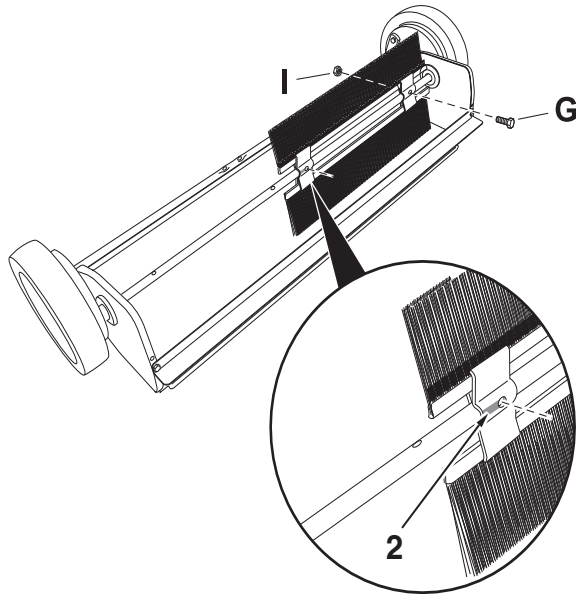

Figure 3

STEP 4: (SEE FIGURE 4)

- Install the brush with retainer marked black (3) onto the brush shaft and secure in place with 1/4-20 x 1" hex bolts (G) and 1/4-20 nylock nuts (I).

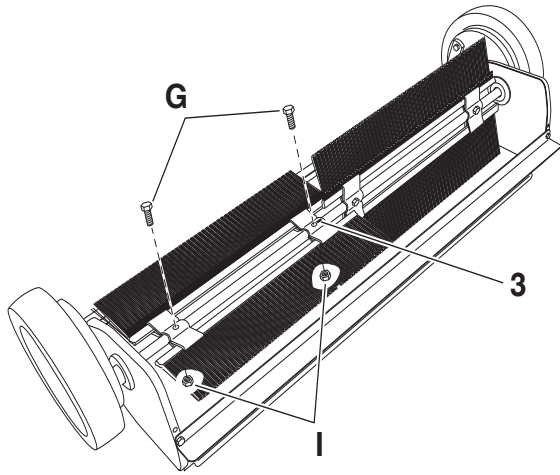

Figure 4

STEP 5: (SEE FIGURE 5)

- Attach the right hitch tube (9) to the sweeper body using 5/16-18 x 1-1/2" carriage bolts (C) and 5/16-18 nylock nuts (J). Hand-tighten.

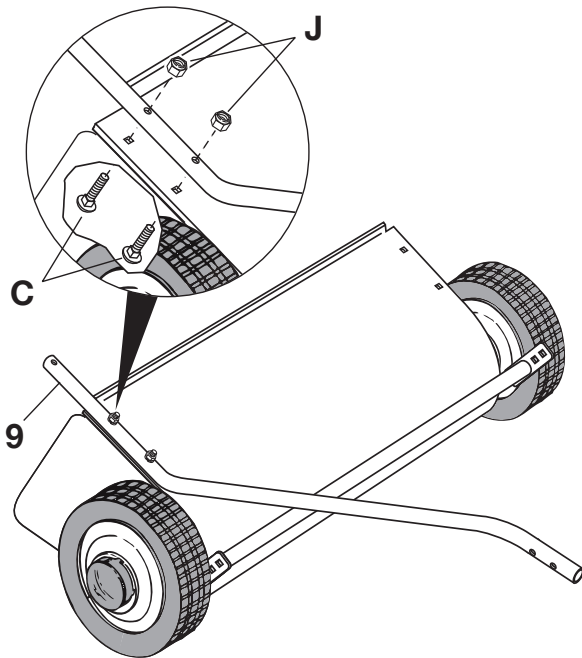

Figure 5

STEP 6: (SEE FIGURE 6)

- Repeat step 5 for the left hitch tube.
- Secure the hitch tubes together using 5/16-18 x 2-1/2" hex bolts (A) and 5/16-18 nylock nuts (J). Hand-tighten.

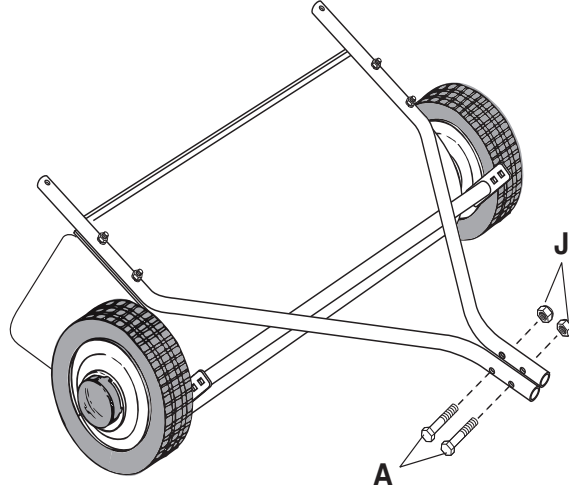

Figure 6

STEP 7: (SEE FIGURE 7)

- Attach the hitch bracket (12) and straight hitch bracket (13) based on your measurement requirements using 5/16-18 x 2" hex bolts (B) and 5/16-18 nylock nuts (J).
- Continue with a hitch pin (Y), hitch spacer tubes (U), and a 1/8" hair cotter pin (M). Hand tighten.

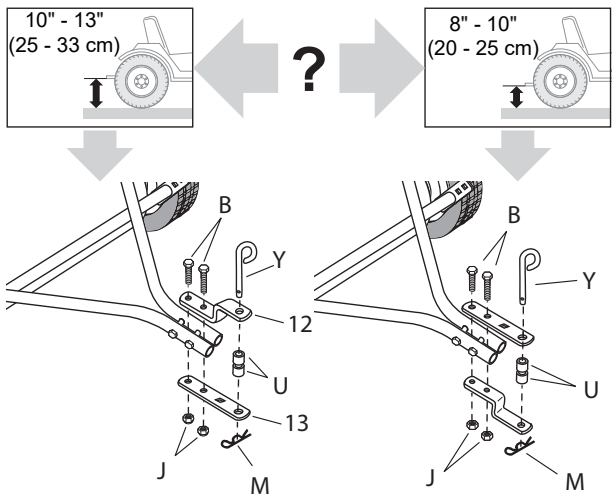

Figure 7

STEP 8: (SEE FIGURE 8)

- Securely tighten all of the hardware.

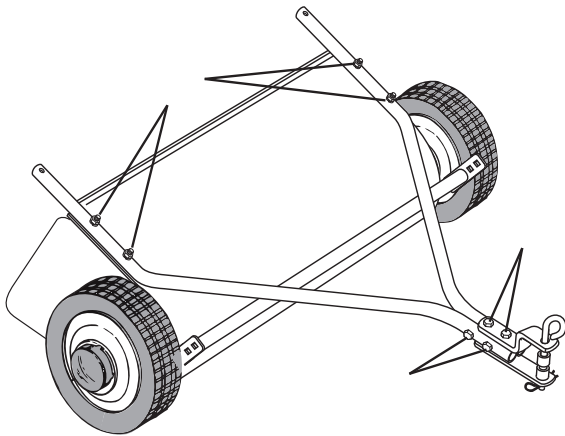

Figure 8

STEP 9: (SEE FIGURE 9)

- Attach the handle (10) to the left side of the sweeper assembly using 5/16-18 x 1" hex bolts (E), 5/16" flat washers (K), and 5/16-18 nylock nuts (J). Securely tighten.
- Slide the height adjustment grip (W) onto the handle (10).

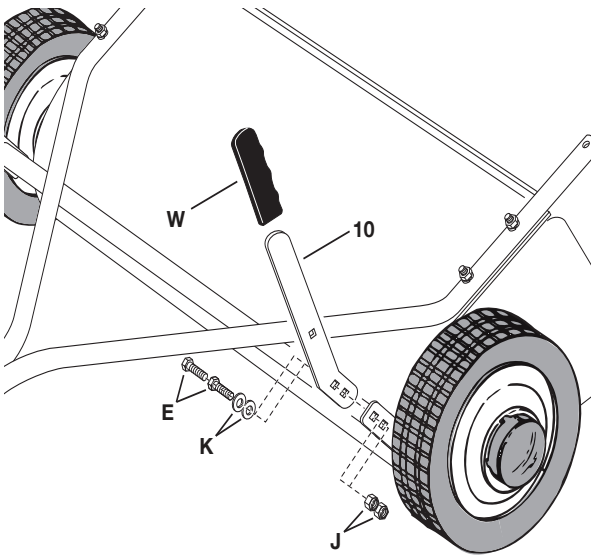

Figure 9

Quick Start Guide

45-03202 Tow Behind Sweeper

Read the manual that came with your Tow Sweeper for:

- Important safety warnings
- Further explanation of features
- Operating instructions and flow control adjustments

Problem?
Call 1-800-448-9282

Agri-Fab

Quick Start Guide

45-03202 Tow Behind Sweeper

Read the manual that came with your Tow Sweeper for:

- Important safety warnings
- Further explanation of features
- Operating instructions and flow control adjustments

Problem?
Call 1-800-448-9282

Agri-Fab

STEP 10: (SEE FIGURE 10)

- Attach the rear of the height adjustment strap (11) to the sweeper assembly using a 5/16-18 x 1-1/4" hex bolt (D), 5/16" flat washer (K), pivot bushing (S), spacer bushing (T), and 5/16-18 nylock nut (J).
- Attach the front of the height adjustment strap (11) to the handle (10) using a 5/16-18 x 1" carriage bolt (F), star washer (L), 5/16" flat washer (K), and thread knob (X). Securely tighten all hardware.

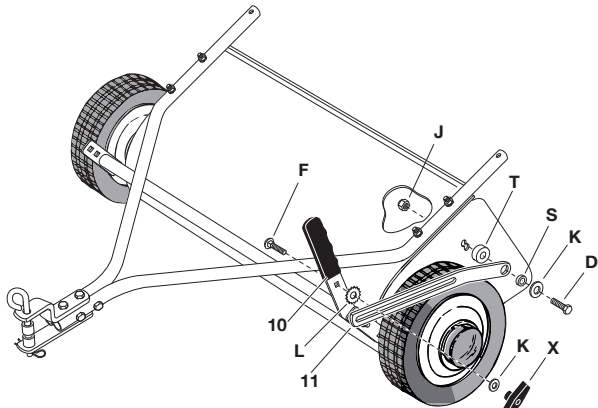

Figure 10

STEP 11: (SEE FIGURE 11)

- Slide the bag frame strap (6) into the front of the hopper bag.

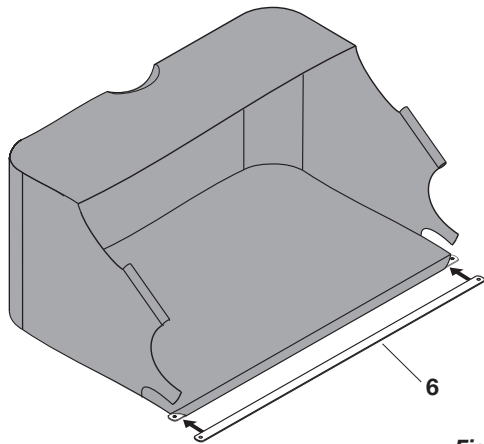

Figure 11

STEP 12: (SEE FIGURE 12)

- Insert a rear hopper tube (1) into the hopper bag.

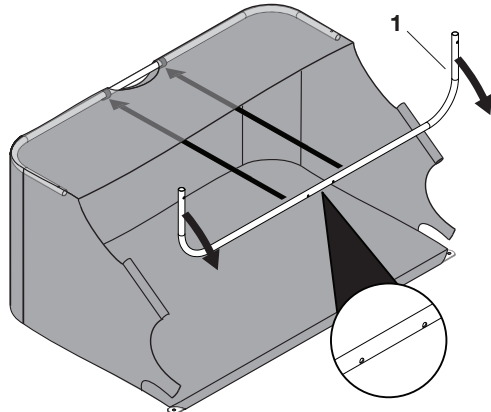

Figure 12

STEP 13: (SEE FIGURE 13)

- Slide the upper hopper tubes (2) into each side of the hopper bag.

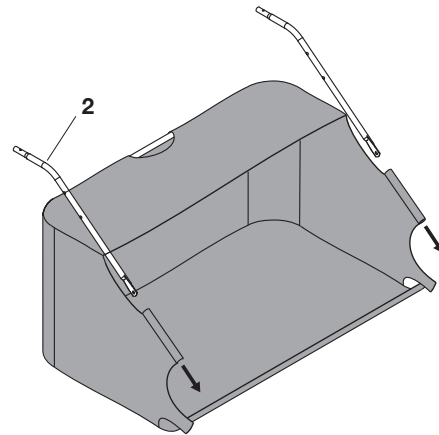

Figure 13

STEP 14: (SEE FIGURE 14)

- Slide the upper hopper tubes (2) into the rear hopper tube (1) and connect together using 1/4" x 1-1/8" clevis pins (P) and 3/32" hair cotter pins (N).

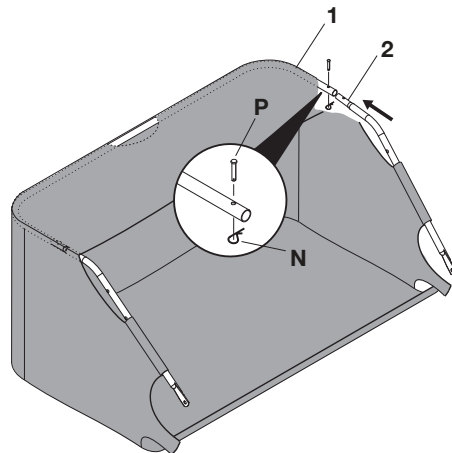

Figure 14

STEP 15: (SEE FIGURE 15)

- Connect the lower hopper tubes (3) to a rear hopper tube (1) using 1/4" x 1-1/8" clevis pins (P) and 3/32" hair cotter pins (N).

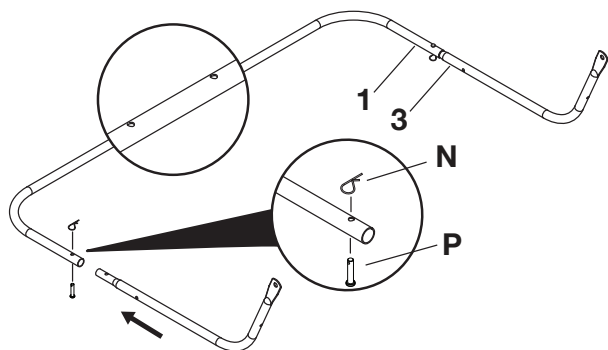

Figure 15

STEP 16: (SEE FIGURE 16)

- Slide the lower hopper tube assembly into the bottom of the hopper bag.

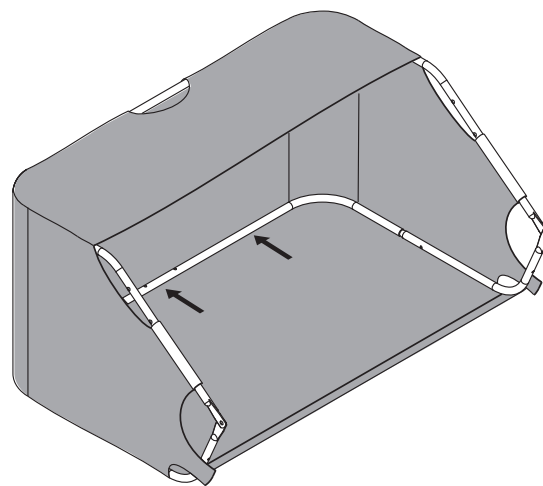

Figure 16

STEP 17: (SEE FIGURE 17)

- Connect the tube assemblies together on each side using 3/8" x 1/2" clevis pins (O) and 3/32" hair cotter pins (N).

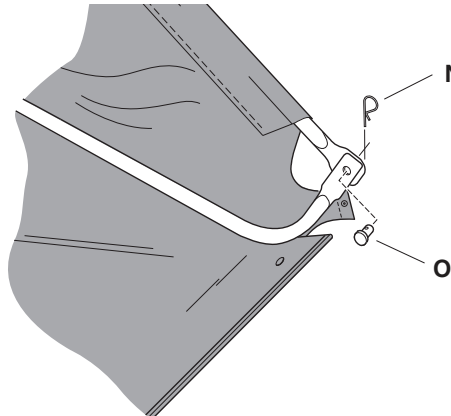

Figure 17

STEP 18: (SEE FIGURE 18)

- Connect the tube assembly to the hopper bag using 1/4" x 1-1/8" clevis pins (P) and 3/32" hair cotter pins (N).

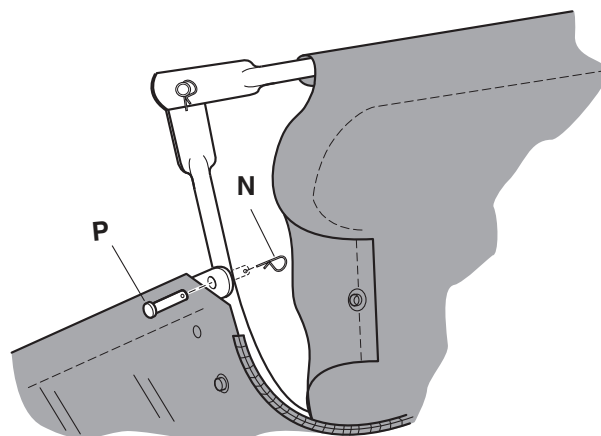

Figure 18

STEP 19: (SEE FIGURE 19)

- Snap the hopper bag together at the corners.

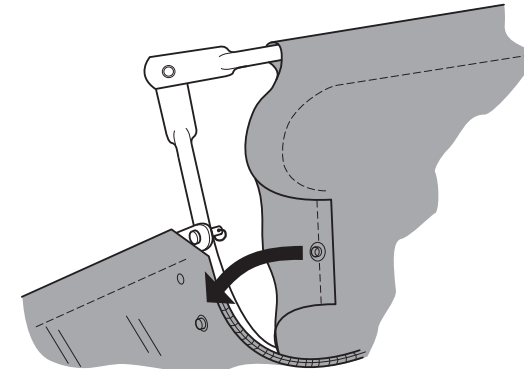

Figure 19

STEP 20: (SEE FIGURE 20)

- Place the hopper support rods (4) into the bag assembly.

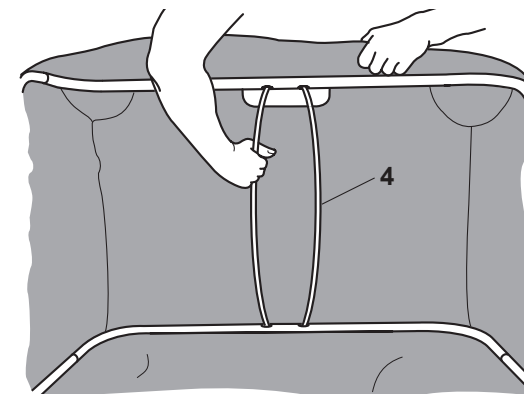

Figure 20

STEP 21: (SEE FIGURE 21)

- Attach the bag arm tubes (8) to each side of the hopper bag assembly using 3/8" x 2.25" clevis pins (R) and 3/32" hair cotter pins (N).
- Place vinyl caps (V) on top of the bag arm tubes (8).

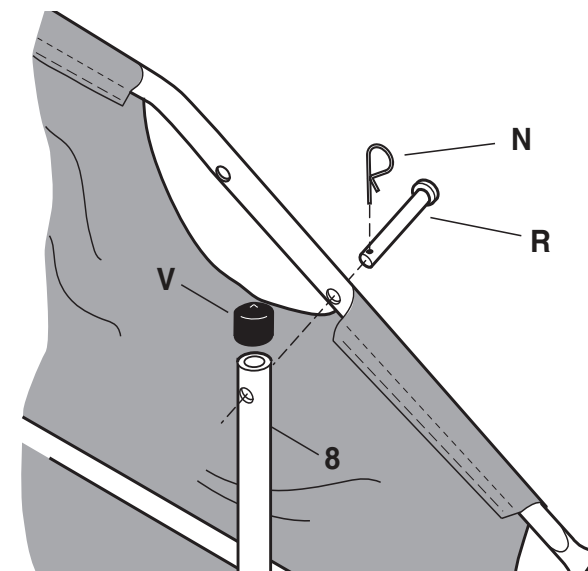

Figure 21

STEP 22: (SEE FIGURE 22)

- Tie the hopper rope onto the hopper bag assembly.

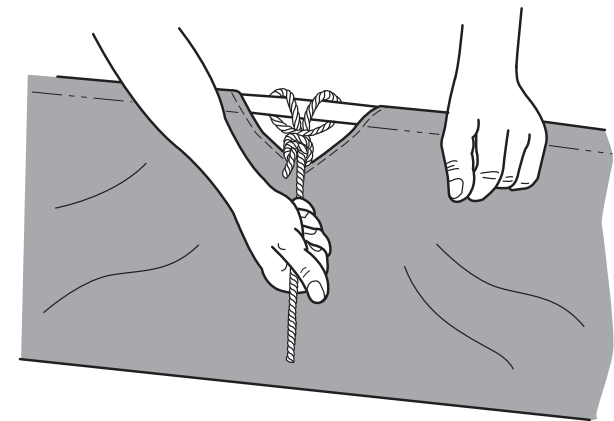

Figure 22

STEP 23: (SEE FIGURE 23)

- Connect the hopper bag assembly to the sweeper assembly using 1/4" x 1-3/4" clevis pins (Q) and 3/32" hair cotter pins (N).

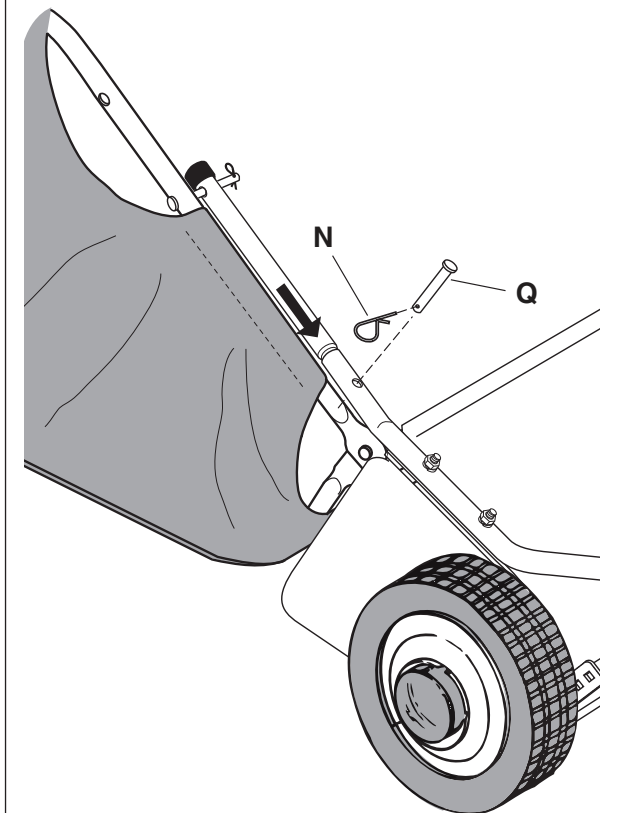

Figure 23