

HARDWARE PACKAGE

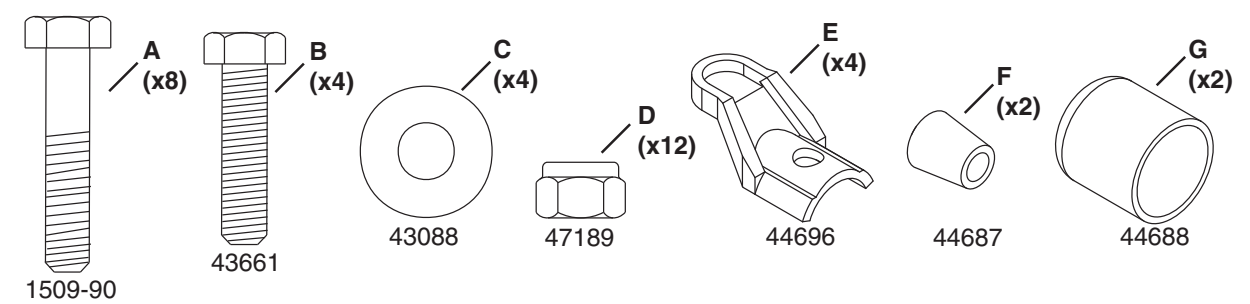

TOOLS REQUIRED FOR ASSEMBLY

- (1) Adjustable Wrench
- (2) 7/16" Wrenches

STEP 1: (SEE FIGURE 1)

- Turn the sweeper upside down.
- Place a brush assembly on the brush shaft, with the short ends of the brushes at the center of the sweeper and the overlap bristles of the top brush facing out.
- Install two 1/4" x 1" hex bolts (B) and 1/4" nylock nuts (D).
- Rotate the brushes 1/4 turn and repeat for the second brush.

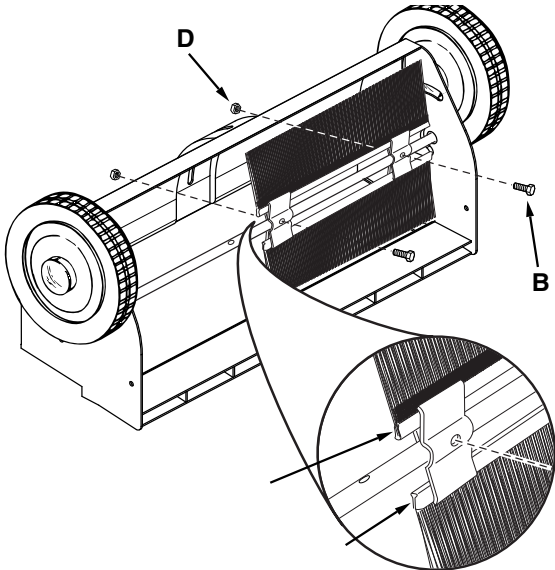

Figure 1

STEP 2: (SEE FIGURE 2)

- Turn the sweeper upright and assemble the two handle leg stand tubes (4) to the sweeper housing using two 1/4" x 1-1/4" hex bolts (A), flat washers (C), and 1/4-20 nylock nuts (D) per handle. Hand tighten.

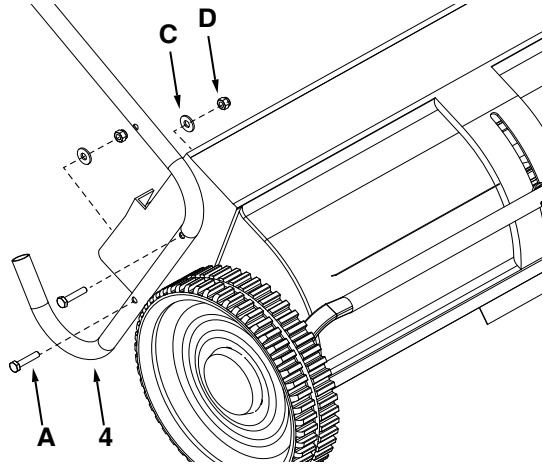

Figure 2

STEP 3: (SEE FIGURE 3)

- Assemble the upper handle tube (3) onto the handle leg stand tubes (4).
- Align holes in the handle and assemble the bag rod clips (E) to the handle and fasten with 1/4" x 1-1/4" hex bolts (A) and 1/4-20 nylock nuts (D).
- Tighten the bolts.

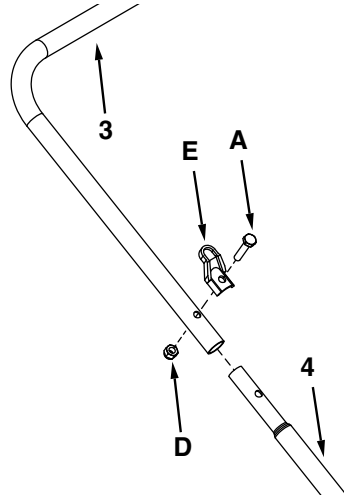

Figure 3

STEP 4: (SEE FIGURE 4)

- Assemble a bag rod clip (E) to the inside of each lower handle tube using a 1/4" x 1-1/4" hex bolt (A) and a 1/4" nylock nut (D).
- Ensure the clips face towards the sweeper housing.

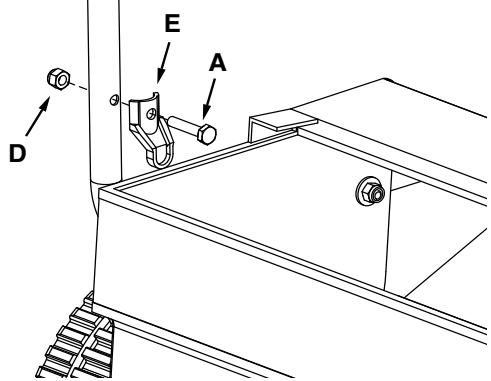

Figure 4

STEP 5: (SEE FIGURE 5)

- Slide the bent bag rod (6) through the stitched bag flap on the top of the hopper bag (2).
- Slide the lower bag rod (5) through the stitched bag flap on the bottom of the bag.

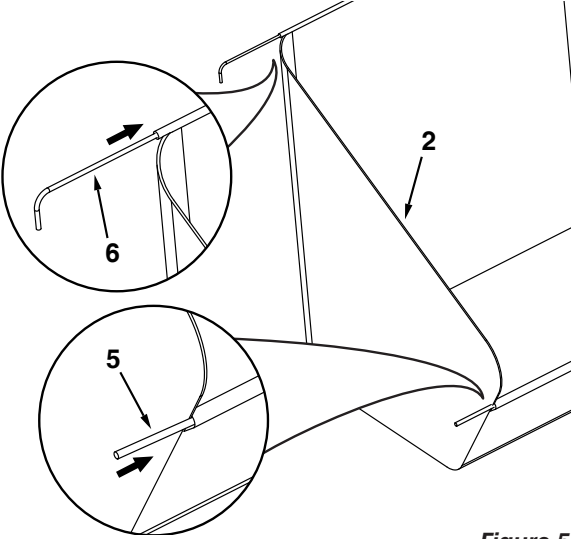

Figure 5

STEP 6: (SEE FIGURE 6)

- Assemble the two plastic rod caps (F) to the rod ends of the lower bag rod (5).

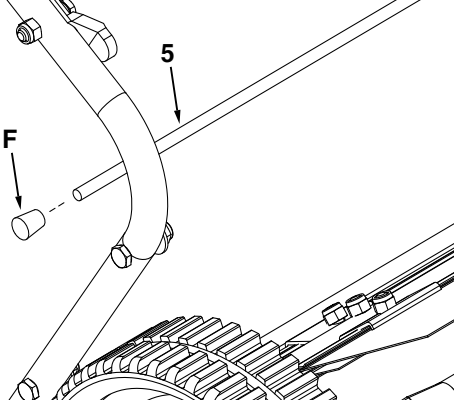

Figure 6

STEP 7: (SEE FIGURE 7)

- Assemble the two plastic caps (G) onto the ends of the leg stands (4).

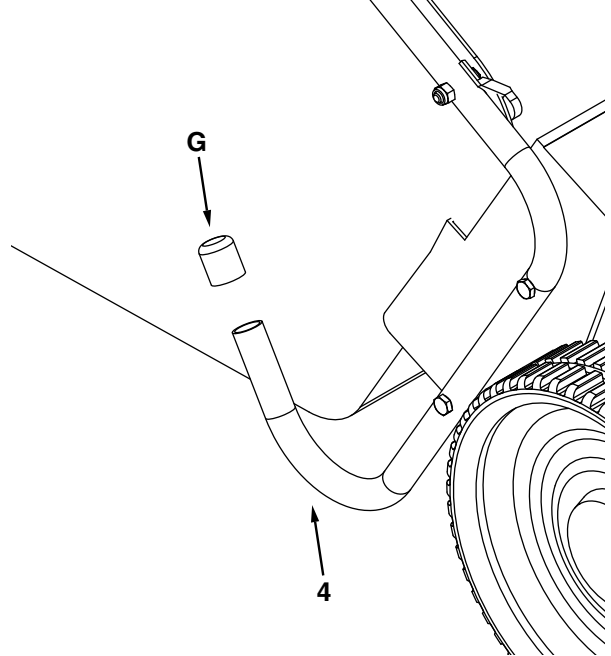

Figure 7

STEP 8: (SEE FIGURE 8)

- Place the upper hopper bag and bent bag rod (6) into the bag rod clips (E) on the hopper handle (3).

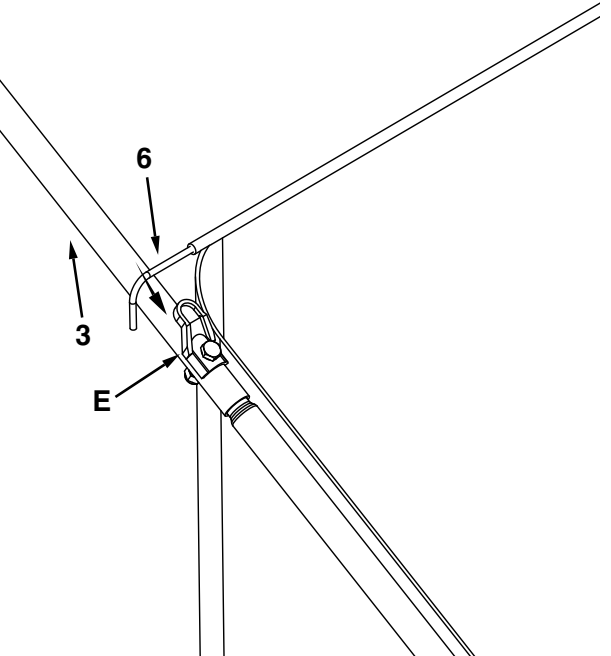

Figure 8

STEP 9: (SEE FIGURE 9)

- Place the lower hopper bag and bag rod (5) into the opening on the sweeper housing.

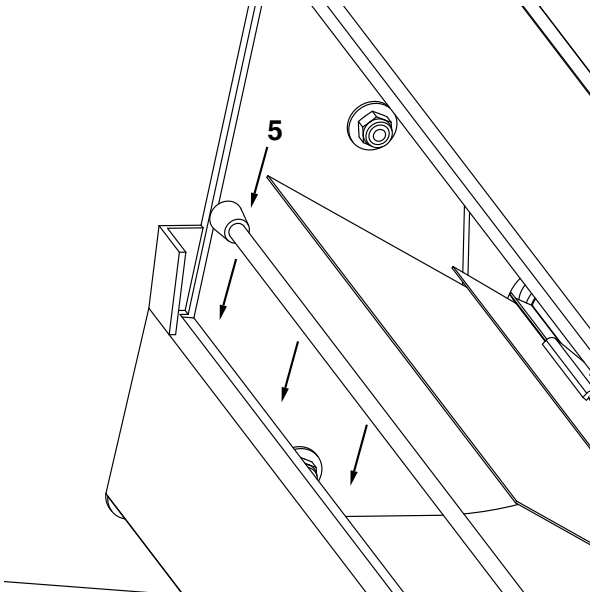

Figure 9

STEP 10: (SEE FIGURE 10)

- Hook the elastic straps on the bag flaps under the bag rod clips (E) on the lower handle tubes (4).

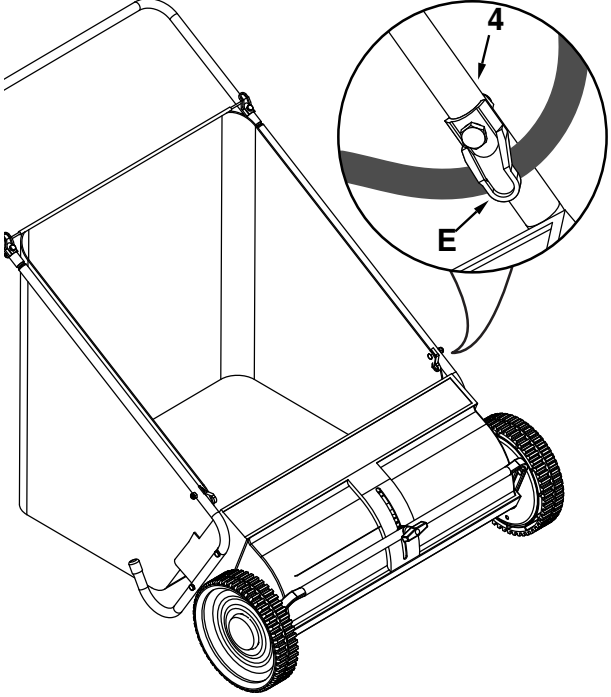

Figure 10