

Assembly

Parts in Kit

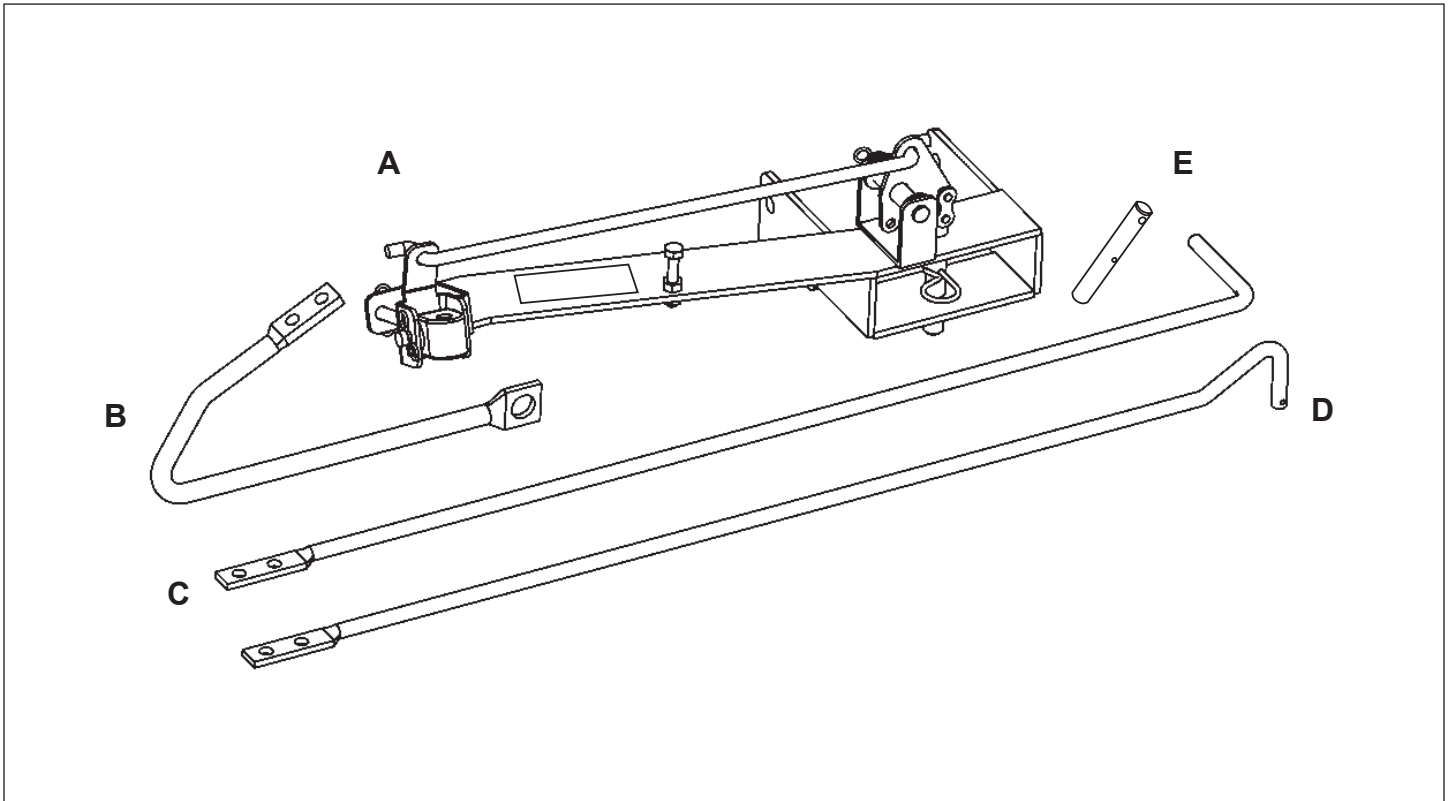

Angling parts

Parts Description	Letter	Qty
Angling Assembly	A	1
Lever Bracket	B	1
Lever Top	C	1
Lever Bottom	D	1

Spare Parts Bag

Parts Description	Letter	Qty
Pin	E	1

Hardware Bag

Parts Description	Qty
Bolt, 3/8 x 5-1/2 in.	2
Nut, 3/8 in.	2
Bolt, 5/16 x 3/4 in.	2
Carriage Bolt, 5/16 x 3/4 in.	2
Nut, 5/16 in.	4
Bolt, 1/2 x 1 in.	1
Locknut, 1/2 in.	1
Spring Clip	1
Spring	1

Template

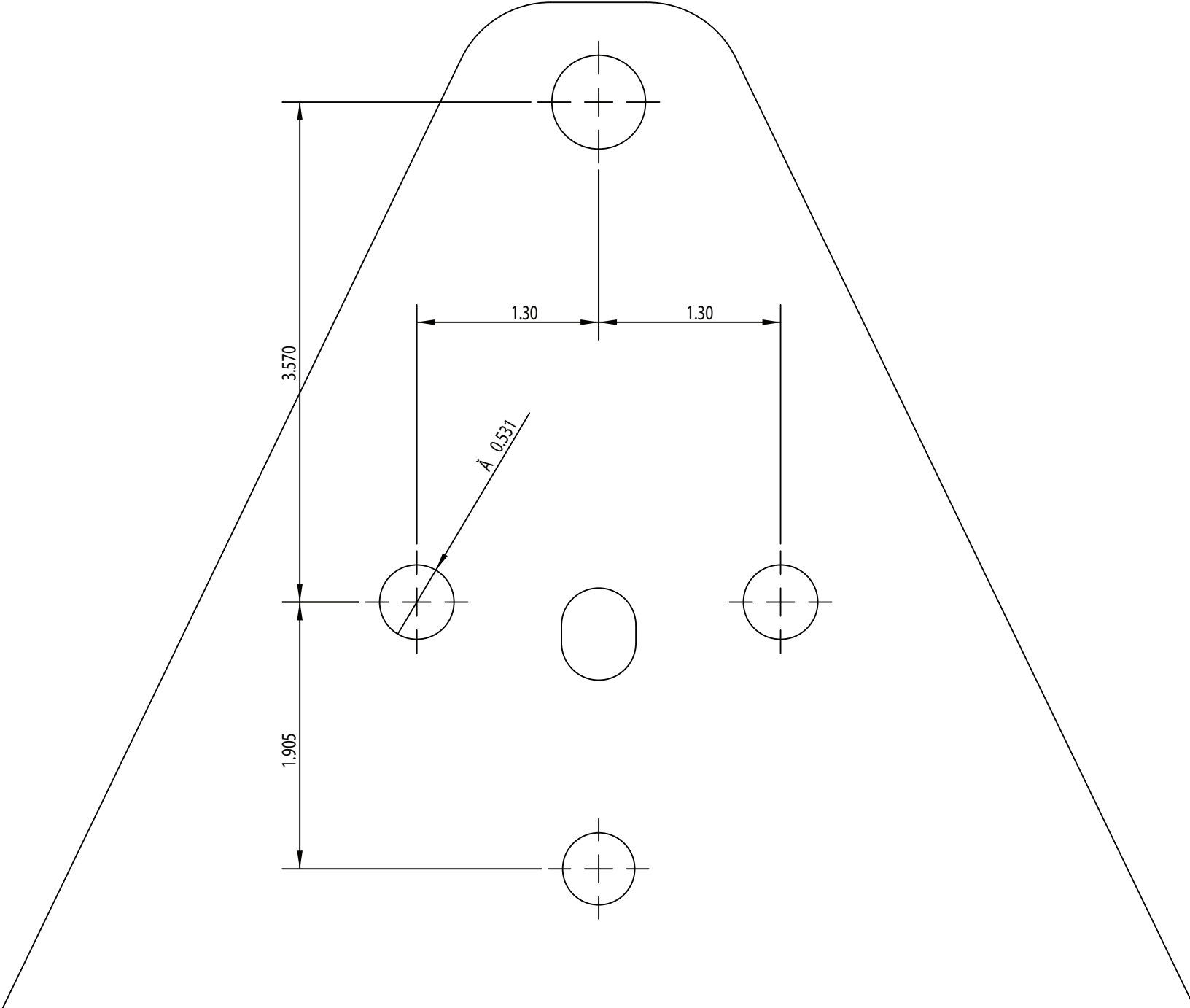

This page intentionally left blank

Good Quality Service

John Deere Quality Continues with Quality Service

John Deere provides a process to handle your questions or problems, should they arise, to ensure that product quality continues with quality parts and service support.

Follow the steps below to get answers to any questions you may have about your product.

Refer to your attachment and machine operator manuals.

In North America or Canada, call 1-800-4ADeere and provide product serial number (if available) and model number.

Warranty

Limited Warranty for New John Deere Licensed Products

Agri-Fab spreaders are guaranteed to be free from defects in material and workmanship from the date of purchase for 1 year residential use, 6 months commercial use, provided that the purchaser properly assembles, installs, uses and maintains the products in accordance with this manual.

Purchaser's failure to adhere to such requirements will void the warranty. To the extent permitted by applicable law, all other warranties, representations, obligations and conditions, expressed or implied, including but not limited to implied warranties of merchantability, fitness for any particular purpose and non-infringement, are hereby disclaimed and excluded.

Any product which does not meet warranty shall, as purchaser's sole and exclusive remedy, be repaired or replaced by Agri-Fab. This warranty is non-transferable.

In addition, our warranty does not cover:

- Labor charges
- Loss or consequential, incidental or special damages of any kind.

This product was manufactured by Agri-Fab a John Deere Licensee, located at 809 S Hamilton St Sullivan, IL 61951.. If you have any questions or concerns with the assembly, installation, or operation of this attachment, see your local John Deere dealer or call Agri-Fab at 1-800-448-9282 for assistance.

