

OWNERS MANUAL

**MODEL NO.
45-01762**

CAUTION:
Read Rules for
Safe Operation
and Instructions
Carefully

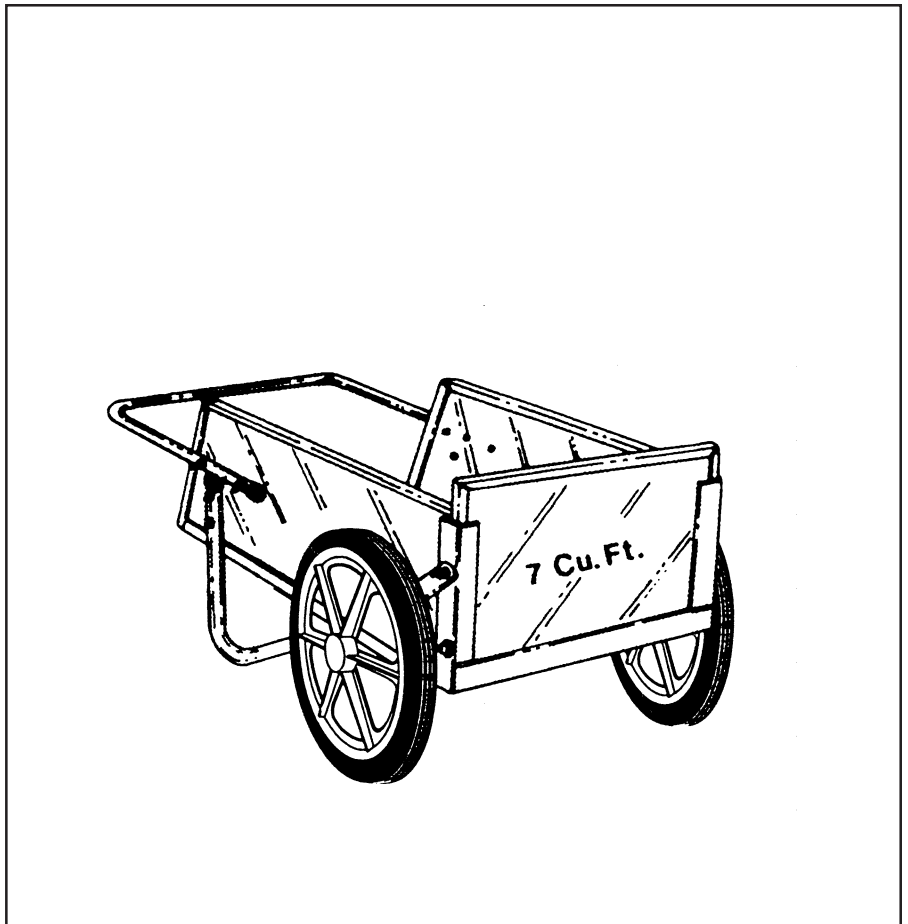

7 CU. FT. FARM/YARD CART

- Safety
- Assembly
- Operation
- Maintenance
- Parts

RULES FOR SAFE OPERATION

Preventing accidents is the responsibility of every equipment operator. The following general safety precautions must be fully understood and followed by every operator.

1. Do not at any time carry passengers in this cart. It is designed for carrying materials only and not intended to carry passengers.
2. Be careful on any grade (hill) and stay off of steep grades.
3. Use caution when loading cart to avoid tipping.
4. Avoid large holes and ditches when transporting loads.

Your Farm/Yard Cart carton contains a hardware package with parts as shown in the chart below and in figure 1.

Contents of Hardware Pack: (See figure 1)

| REF. | QTY. | DESCRIPTION |
|------|------|---|
| A | 8 | Screws, 1/4-20 x 2" Long |
| B | 4 | Screws, 1/4-20 x 1-1/4" Long |
| C | 13 | Screws, 1/4-20 x 1" Long |
| D | 4 | Tube Cap, 1" x 1" Long |
| E | 25 | Hex Nuts, 1/4-20 Thread |
| F | 25 | Flat Washer, 1/4" I.D. |
| G | 4 | Flat Washers, 25/32" I.D. x 1-1/2" O.D. |
| I | 2 | Cotter Pins |

HARDWARE REFERENCE CHART

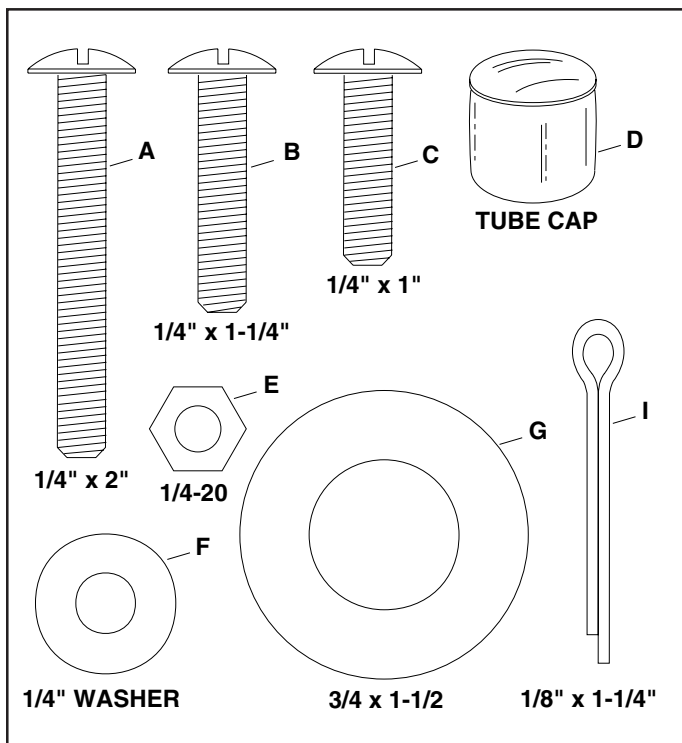

FIGURE 1

ASSEMBLY INSTRUCTIONS

TOOLS REQUIRED

- (1) Screw Driver
- (1) Pliers
- (1) 7/16" Wrench

When assembling your cart, place the heads of all screws to the inside and hex nuts with flat washers to the outside.

1. Lay the front angle assembly down (flat) on floor and stand the bottom panel in position as shown in figure 2.



The bottom panel has one galvanized edge; this is the rear. The front edge has three holes. See figure 2.

2. Line up three holes in bottom panel with holes in front angle assembly. Start three 1/4" x 1" screws through bottom panel, then through angle. Secure screws with flat washers and hex nuts. Tighten securely. See figure 2.

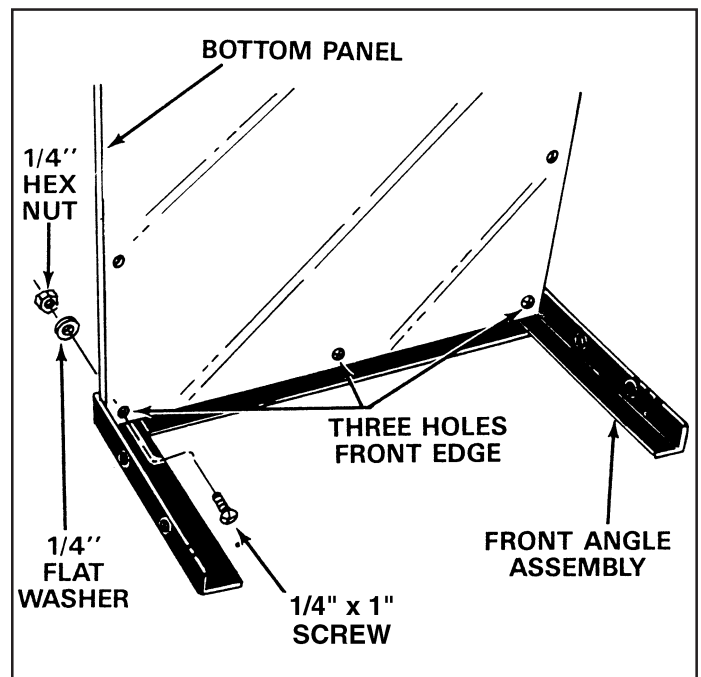

FIGURE 2

3. Turn the front angle assembly and bottom panel upside down as shown in figure 3.
4. Lay the two side angles on the bottom panel so that the axle sleeves are closer to the front angle assembly. See figure 3.
5. Secure both side angle assemblies to the bottom panel using six 1/4" x 1" screws, flat washers and hex nuts. Make only finger tight until all six screws are in place, then tighten securely. See figure 3.

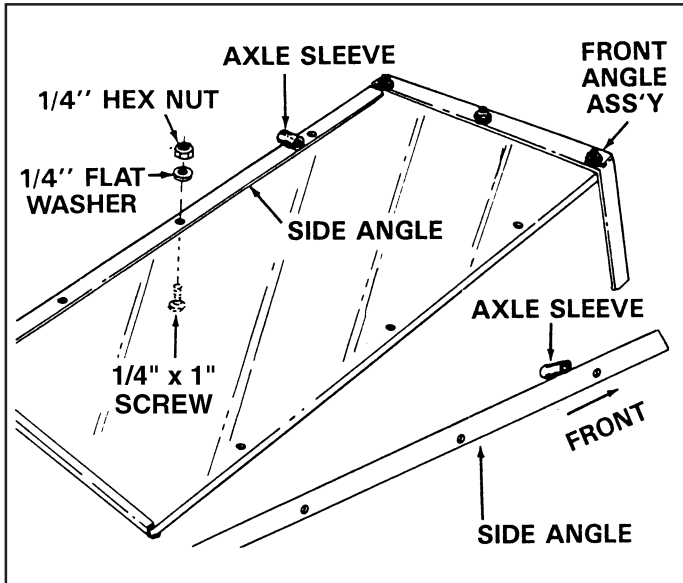

FIGURE 3

6. Stand the cart on its front end with the front angle assembly on the floor. See figure 4.
7. Temporarily place four large 1-1/2" dia. flat washers (used on wheel axle) on the inside of front angle assembly. See figure 4.

NOTE

These washers act as shims and are just for assembly purposes. You will remove them later to use on axle.

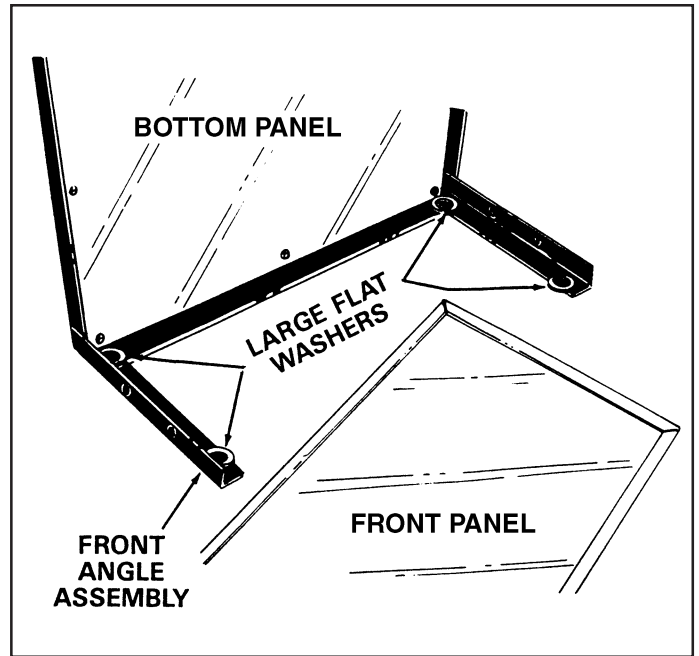

FIGURE 4

8. Lay the front panel down onto the front angle assembly, on top of the four large washers. See figure 5.

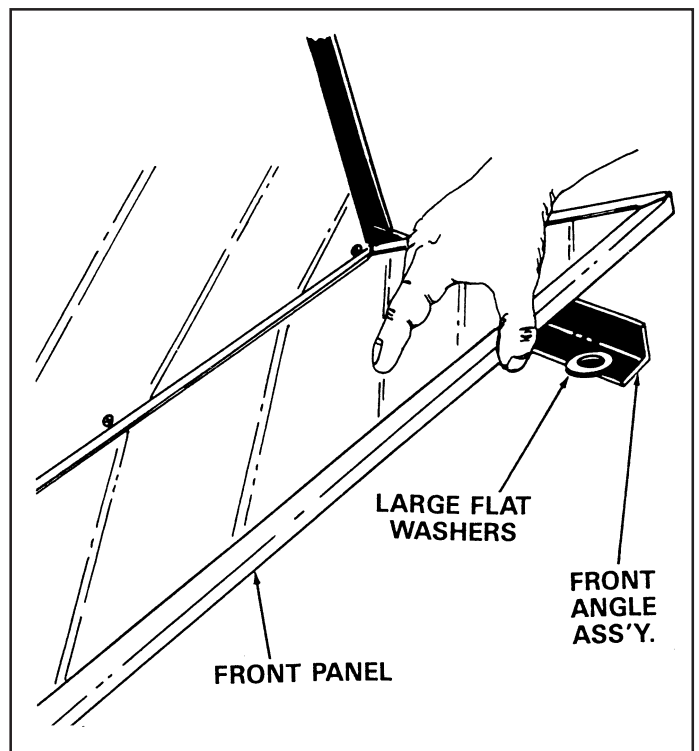

FIGURE 5

9. Place one side panel in position against a side angle and down on top of the front panel. Start one 1/4" x 1" screw through the **center hole** in side panel and side angle. Secure with hex nut and flat washer. See figure 6. **Make only finger tight at this time.**
10. Start one 1/4" x 1-1/4" screw through front hole on side panel and side angle. Start another 1/4" x 1-1/4" screw through top hole on side panel and front angle assembly. Next, place a support strap over these two screws and secure it with flat washers and hex nuts, **making only finger tight at this time.** See figure 6.
11. Repeat steps 9 and 10 for the other side panel.

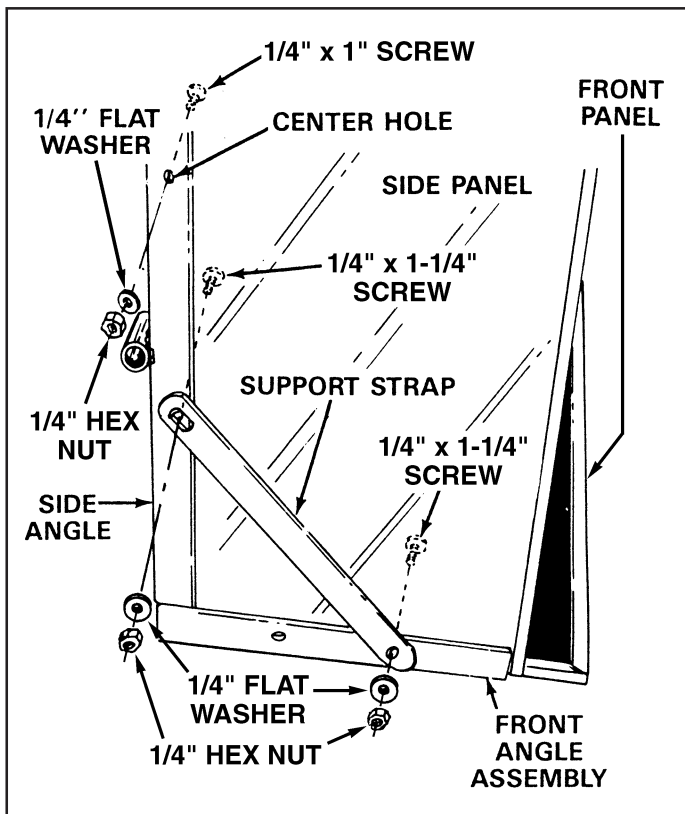

FIGURE 6

12. Assemble one 1/4" x 1" screw through bottom hole in side panel and front angle assembly. Secure with a flat washer and hex nut, **making only finger tight at this time.** See figure 7.
13. Repeat step 12 for the other side panel.
14. Place the axle through axle sleeves as shown in figure 7. Refer also to figure 11 on page 5. **Tighten all loose nuts and screws securely at this time.**

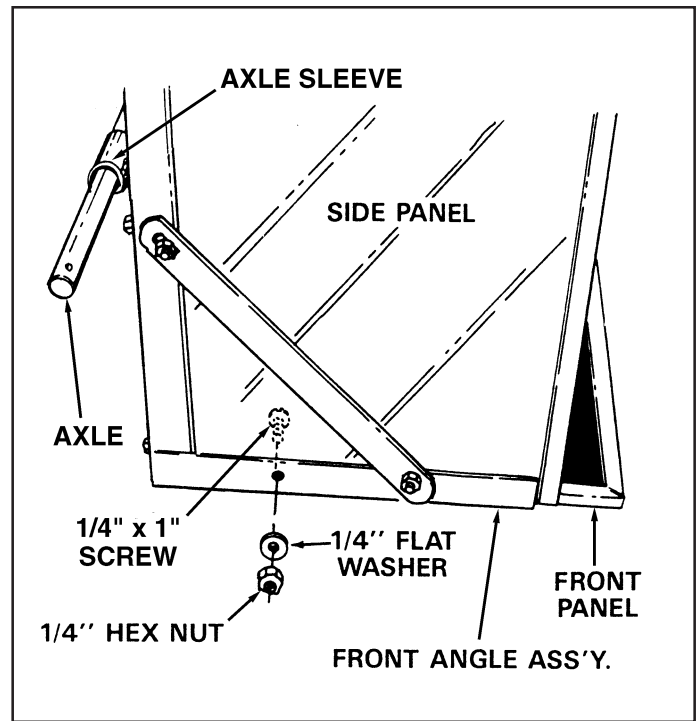

FIGURE 7

15. Lay the cart down on the floor so that the sides are up in a normal position. Remove the front panel by sliding it up, then remove the four large washers you used for shims. See figure 8.

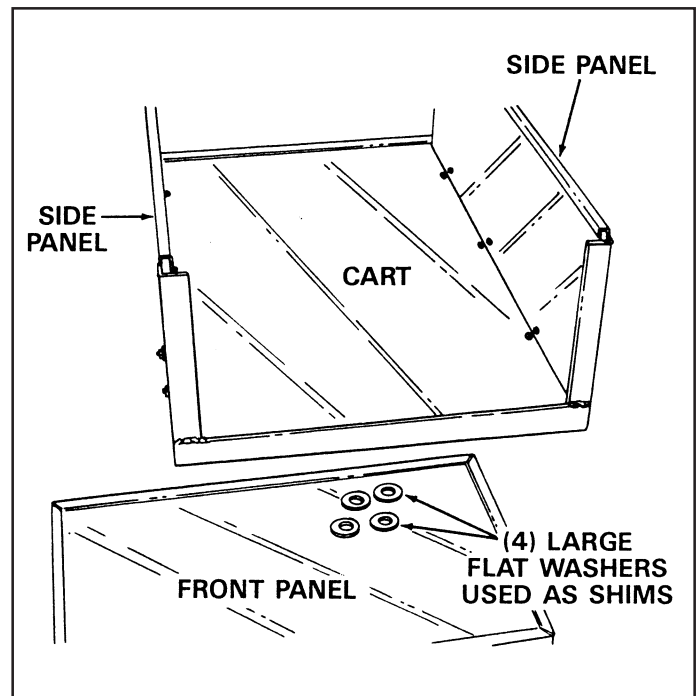

FIGURE 8

16. Stand cart up on its front end again. Place tube caps on leg tube and assemble the leg tube as shown in figure 9, using four 1/4" x 2" screws through side panels and leg tube. Secure with flat washers and hex nuts. See figure 9.

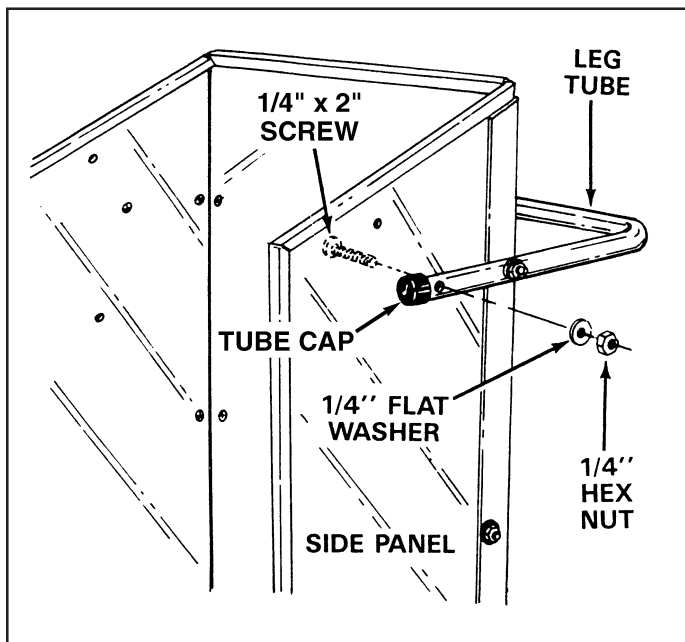

FIGURE 9

17. Leave the cart standing to assemble the handle tube in the next step.

18. Place tube caps on the handle tube, then place it over the side panels and line up the four holes. Assemble four 1/4" x 2" screws through the side panels and handle. Secure with flat washers and hex nuts. See figure 10.

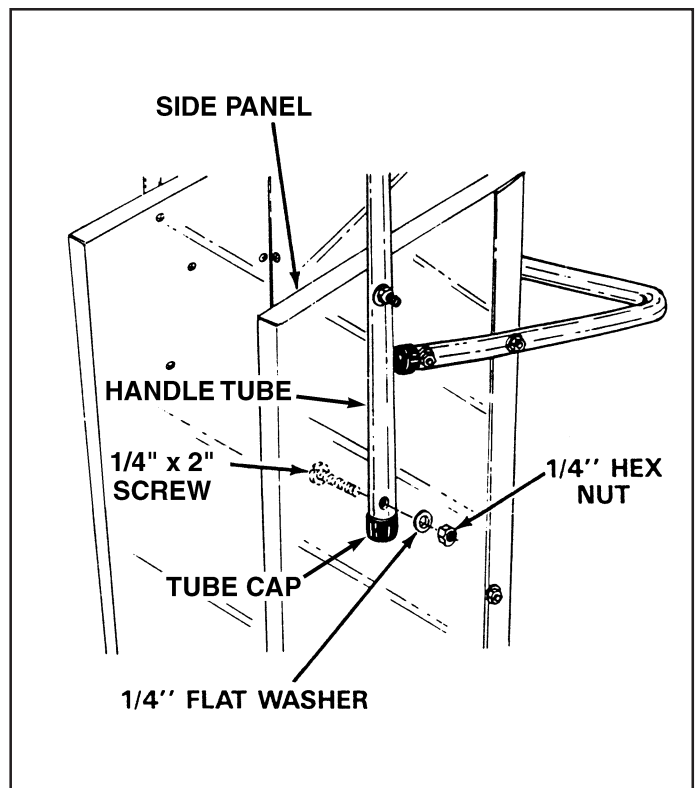

FIGURE 10

19. Lay the cart upside down so that the axle is on top. See figure 11.

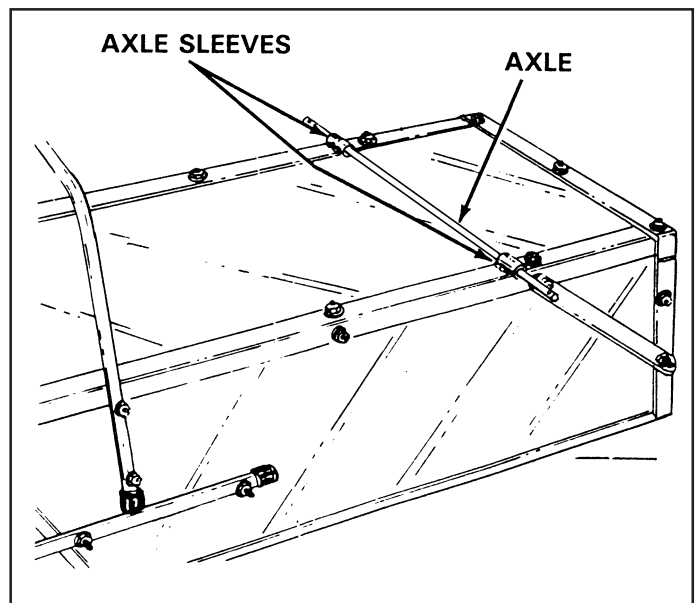

FIGURE 11

20. Place one 1-1/2" dia. flat washer on the axle, then a wheel and then one more 1-1/2" dia. flat washer. Secure wheel to axle with a cotter pin. See figure 12 and note below. Repeat step for other wheel.

NOTE

If cotter pin can not be assembled through hole in the axle ends, remove one washer from inside, next to axle sleeve.

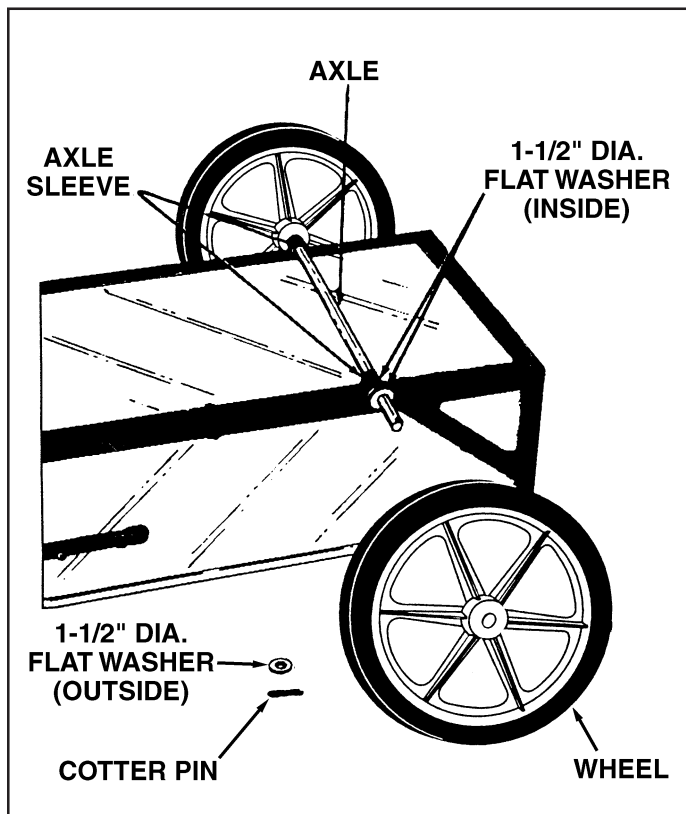

FIGURE 12

21. Turn cart right side up, so that it rests on its wheels.
22. Place front panel in guides to complete assembly.
23. Your cart is now ready to use.

MAINTENANCE

1. Grease or oil wheel bearings occasionally. Use automotive wheel bearing type grease or 20 weight oil.
2. Periodically retighten all screws, especially after heavy use. **Do not exceed load capacity rating of 300 lbs.**
3. Clean cart thoroughly after each use.
4. Store indoors during severe weather.
5. Apply light coat of varnish to all wood surfaces annually.
6. Use glossy black enamel spray paint to touch up scratched or worn painted metal surfaces.

MODEL 45-01762 7 CU. FT. FARM/YARD CART

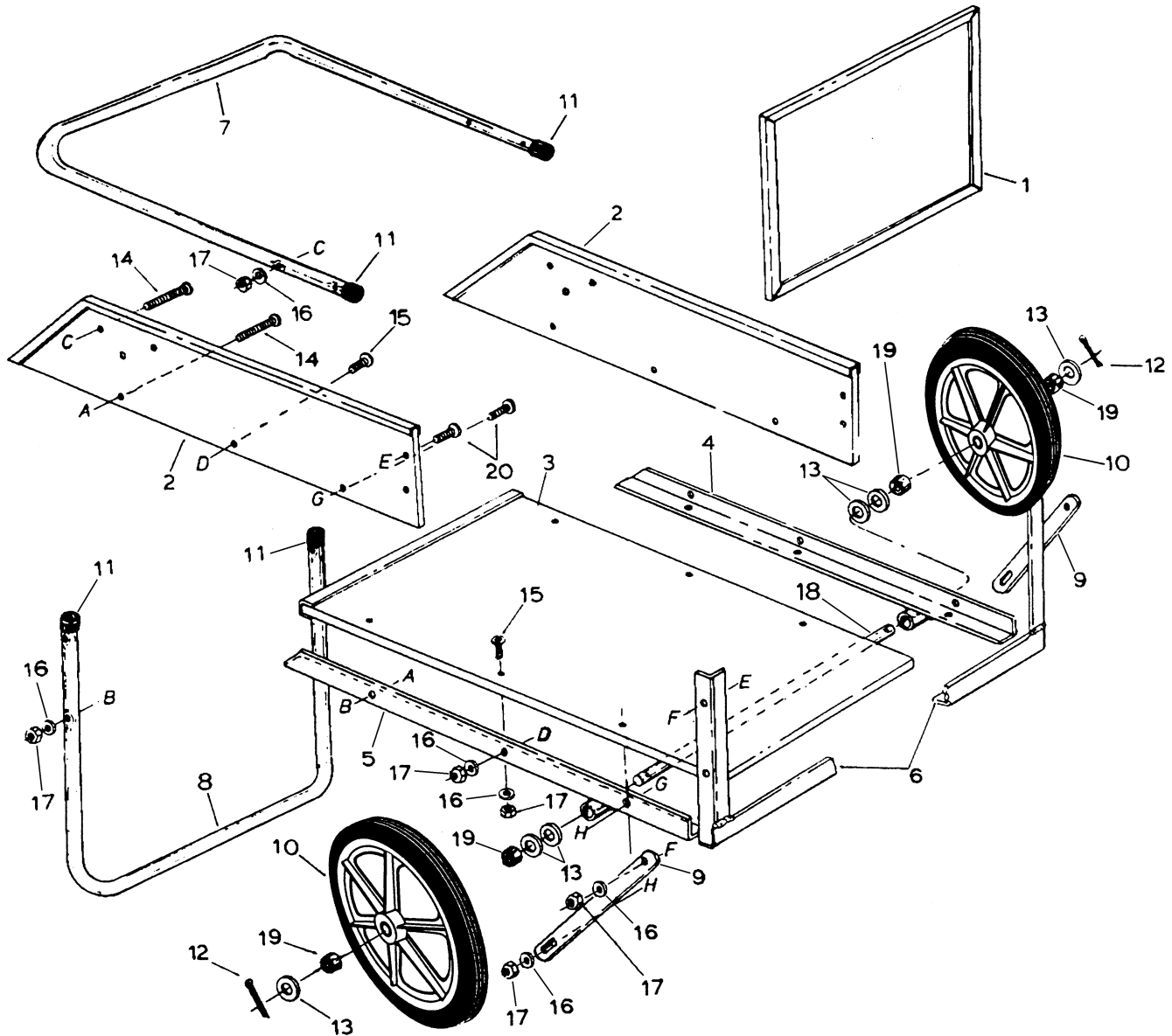

PARTS LIST FOR MODEL NO. 45-01762 FARM/YARD CART

| REF. NO. | PART NO. | QTY. | DESCRIPTION | REF. NO. | PART NO. | QTY. | DESCRIPTION |
|----------|----------|------|--|----------|----------|------|---|
| 1 | 47585 | 1 | Front Panel | 12 | 43010 | 2 | Cotter Pin, 1/8" x 1-1/4" Lg.* |
| 2 | 47586 | 2 | Side Panel | 13 | 43949 | 4 | Flat Washer 25/32" I.D. x 1-1/2" O.D. x 3/32" Thick |
| 3 | 47587 | 1 | Bottom Panel | 14 | 47584 | 8 | Truss Head Screws 1/4-20 x 2" Lg.* |
| 4 | 62527 | 1 | Side Angle Assembly, L.H. | 15 | 44259 | 13 | Truss Head Screws 1/4-20 x 1" Lg.* |
| 5 | 62528 | 1 | Side Angle Assembly, R.H. | 16 | 43088 | 25 | Flat Washer, 1/4" I.D.* |
| 6 | 62529 | 1 | Front Angle | 17 | 43178 | 25 | Hex Nut, 1/4-20 Thread * |
| 7 | 44018 | 1 | Handle Tube | 18 | 23991 | 1 | Axle |
| 8 | 44019 | 1 | Leg Tube | 19 | 44016 | 4 | Bearing, Ball 3/4" I.D. |
| 9 | 23606 | 2 | Support Strap | 20 | 44020 | 4 | Truss Head Screws 1/4-20 x 1-1/4" Lg.* |
| 10 | 44975 | 2 | Wheel Assembly Complete w/Bearings (20") | 47591 | | 1 | Owner's Manual |
| 11 | 44021 | 4 | Tube Caps | | | | |

*Purchase Common Hardware Locally.

REPAIR PARTS
303 West Raymond
Sullivan, IL. 61951
217-728-8388 / www.agri-fab.com