



JOHN DEERE

INSTALLATION INSTRUCTIONS

Electric Lift Kit
ST50576 04/25/2022
ENGLISH
LP64865

Product Compatibility

Compatible with all 2016 and newer X300 series and X500 Series Multi-Terrain tractors.

Required Equipment

- 44" Blade, 48" Blade, 44" Snow Blower or 47" Snow Blower
- Not compatible with heavy front bumper/weight bracket or grill guard

Parts in Kit

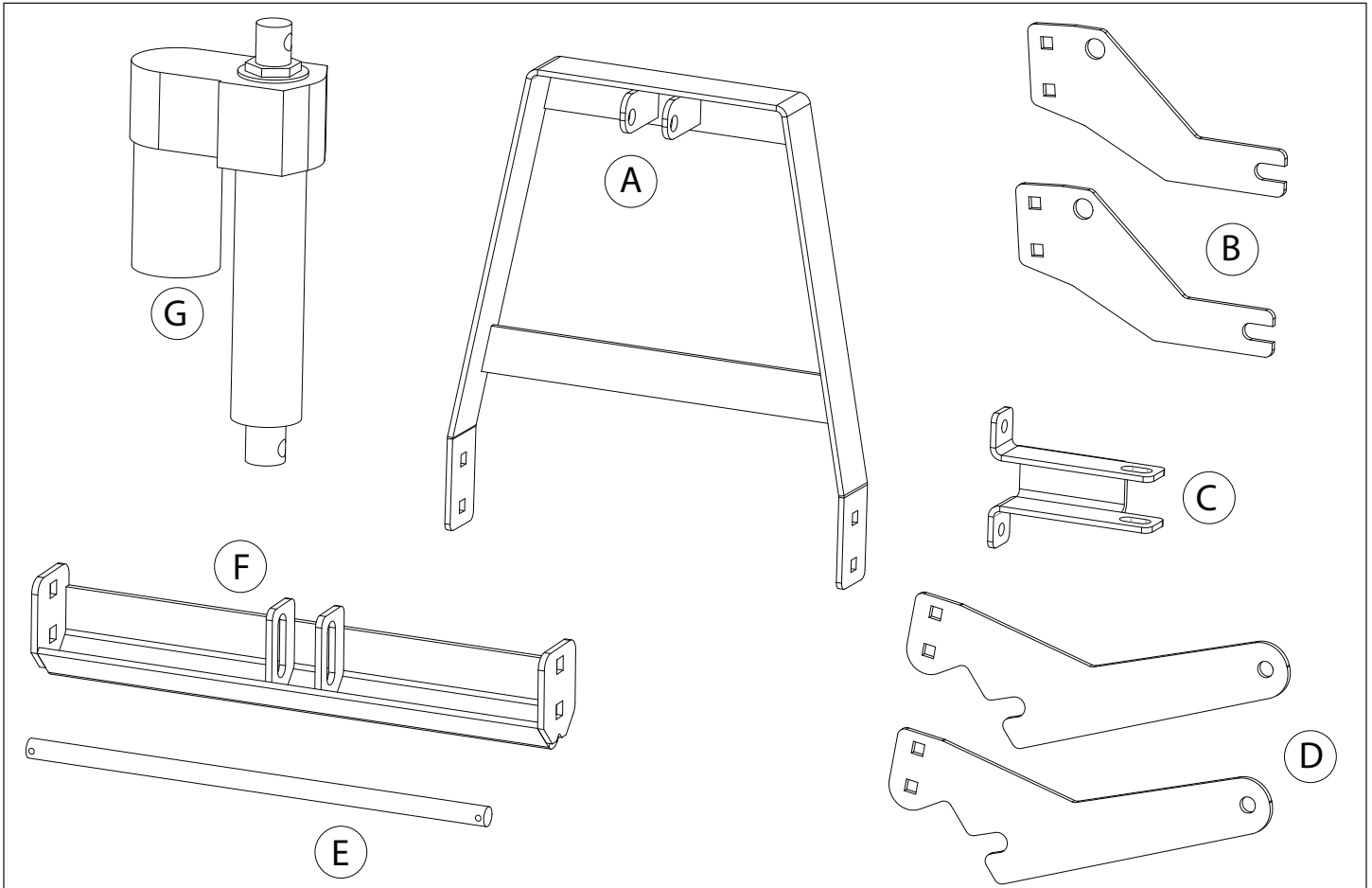

Parts Description	Qty
Frame (A)	1
Frame Side (B)	2
Blade Lift (C)	1
Snow Blower Lift Side (D)	2
Mounting Shaft (E)	1
Snow Blower Lift (F)	1
Actuator (G)	1

Wiring Bag

Parts Description	Qty
Battery Harness	1
Relay Harness	1
Switch	1
Switch Power Wire	1
Wire Ties	5

Equipment

Hardware Bag

Parts Description	Qty
1/2" x 2-1/2" Hex Bolt	2
1/2" Flange Nut	4
3/8" x 3/4" Carriage Bolt	8
3/8" Flange Nut	8
1/2" x 2-1/4" Clevis Pin	2
Small Bow-tie Clip	4
Large Bow-tie Clip	2
3/8" x 1" Flange Bolt	2

Parking Safely

1. Stop machine on a level surface, not on a slope.
2. Disengage mower blades or any other attachments.
3. Engage the park brake.
4. Stop the engine.
5. Remove the key.
6. Wait for the engine and all moving parts to stop before you leave the operator's seat.
7. Close fuel shut-off valve, if your machine is equipped.
8. Disconnect the negative battery cable or remove the spark plug wire (for gasoline engines) before servicing the machine.

Preparing the Machine

Install Front Mount Bolts

1. Assemble a 1/2" hex nut on each 1/2" x 2 - 1/2" hex head bolt until approximately three full threads are visible before the end of the thread.
2. Install a 1/2" x 2 - 1/2" hex head bolt (A) with assembled flange nut (B) into the upper rear mounting hole in the front mount bracket (C) at each side of the machine, from the outside. Secure each bolt with a 1/2" flange nut at the inside of each front mount bracket. Tighten hardware.

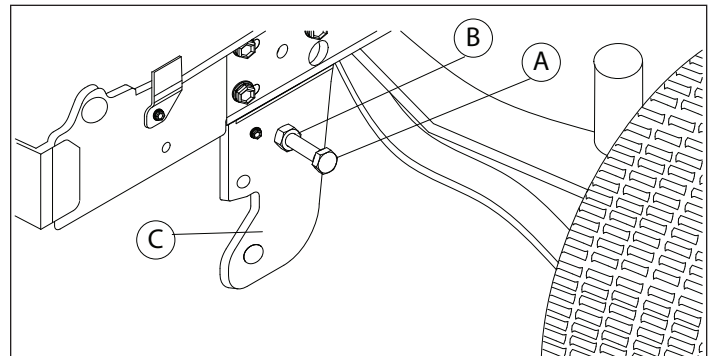

Install Wiring Components

1. Disconnect positive (red) battery cable and temporarily remove the red terminal boot from the cable.
2. Insert the ring terminals for both the positive battery cable (D) and the red wire (E) from the battery harness through the red terminal boot (F). Secure the red ring terminal of the battery harness to the positive (+) battery terminal (G), using the original hardware, and cover the terminal with the terminal boot. Do not connect any wiring to the negative (-) terminal at this time.

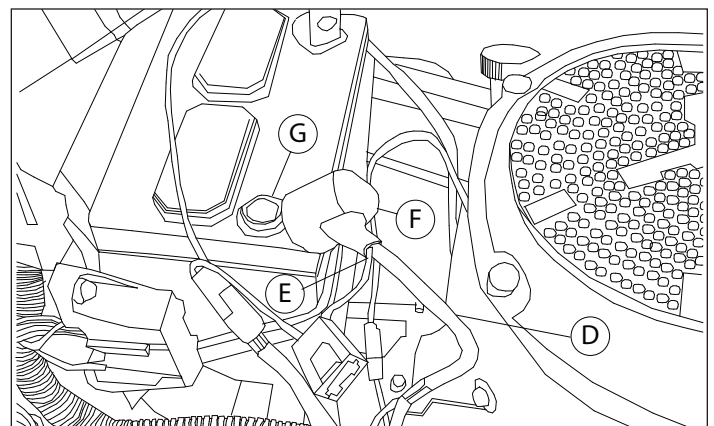

NOTE: Retain these installation instructions with the machine operators manual.

Installation

Install Wiring Components

3. Route the relay harness (H) and relay (J) down along the right side of the battery, between the machine fuse block (K) and battery strap (L). Secure the harness to the lower fuse block mount with a tie wrap (M).

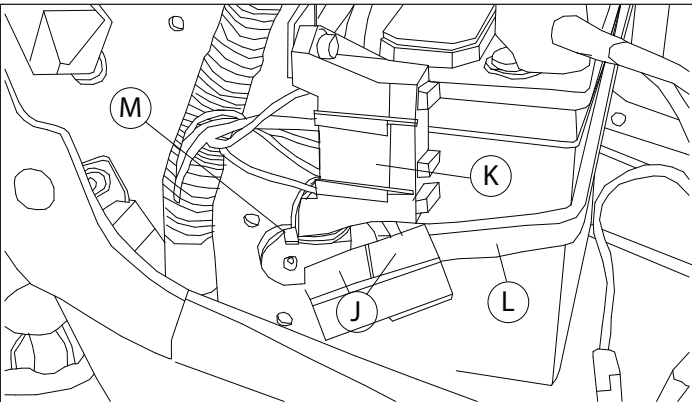
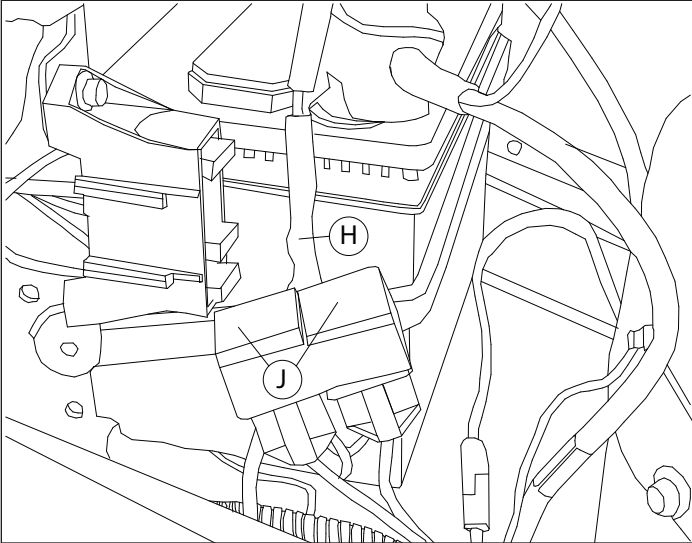

4. Route the harness extension (N) out the bottom of the hood and along the frame to the front of the tractor, avoiding the exhaust (O).

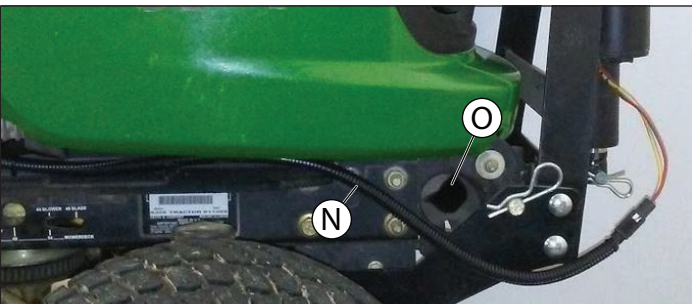

5. Connect the battery harness to the relay harness. Be sure to align black and red wires on the two connectors to ensure proper operation.
6. Connect the relay harness to the actuator when the lift kit is mounted.
7. Locate the brake pedal switch (P) on the left side of tractor frame and unplug the connector.
8. Connect the power wire connector in-line with the brake pedal switch plug. Route and tie wrap the yellow wire (Q) along the tractor harness up to the dash.

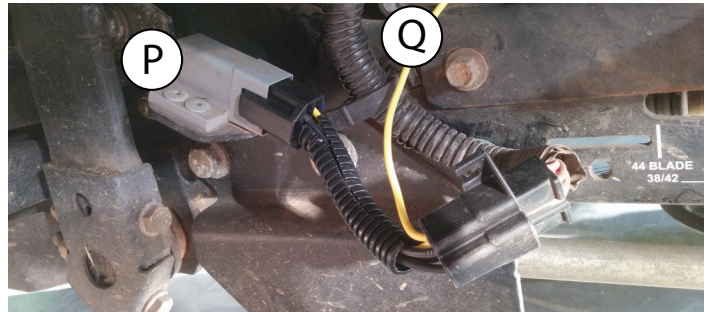

9. Plug the yellow wire into the center terminal on the control switch.
10. Locate a spot on the right side of the dash to mount the switch. Check the backside of the dash for proper clearance. Place sticker on the dash in the desired location and drill a 15/32" or 1/2" hole.

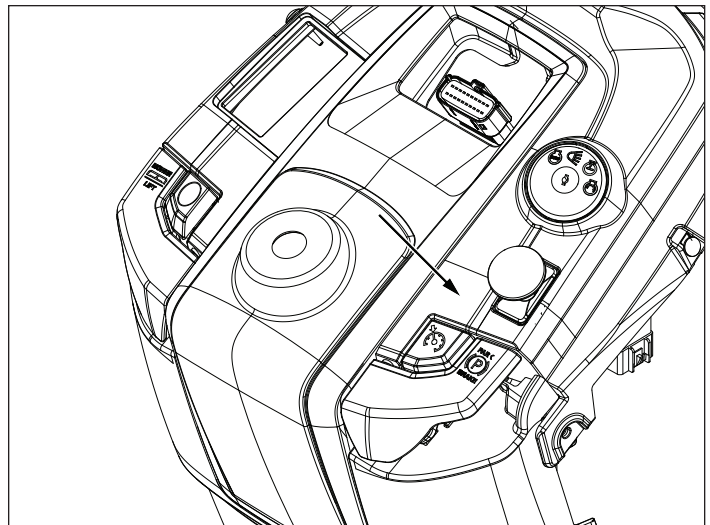

11. Fasten the control switch to the dash with the green wire terminal towards the top of the dash.

Installation

Assembly

1. Connect the Frame (A) to the Frame Sides (B) as shown with four 3/8" x 3/4" Carriage Bolts (C) and 3/8" Flange Nuts (D).

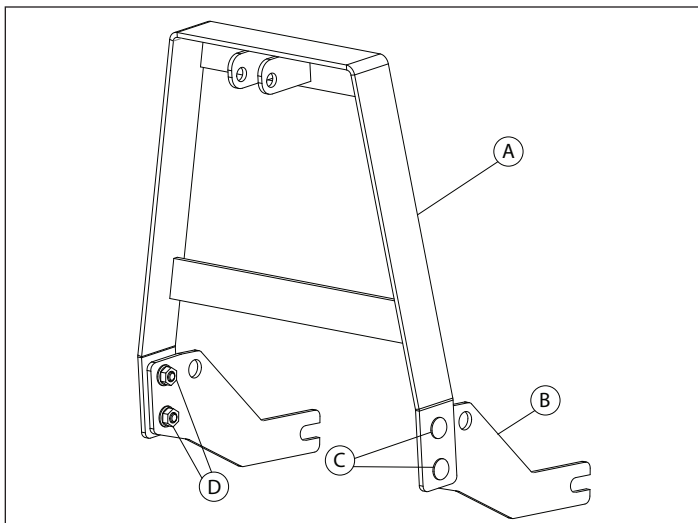

2. Mount the Frame assembly to the tractor by sliding the forked side frame over the bolt (E) and slide Mounting Shaft (F) through the large hole and the bumper. Install two large bow-tie clips in the ends of the mounting shaft.

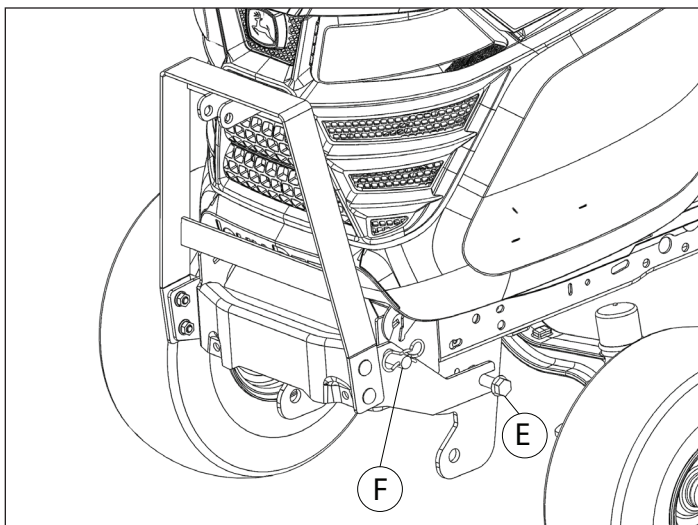

Snow Blower and 48" Blade:

3. Place hole in the Snow Blower Lift Side pieces (G) over the lift pins (H) on the hitch and the slot around the shaft (I). Fasten pin (H) with small bow-tie clip.

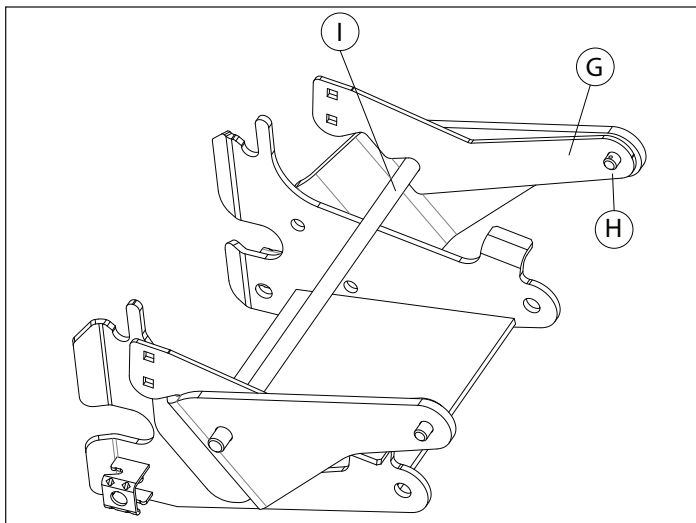

4. Connect the Snow Blower Lift (J) (with the higher side towards the front) to the side pieces using four 3/8" x 3/4" Carriage Bolts (K) and 3/8" Flange Nuts (L).

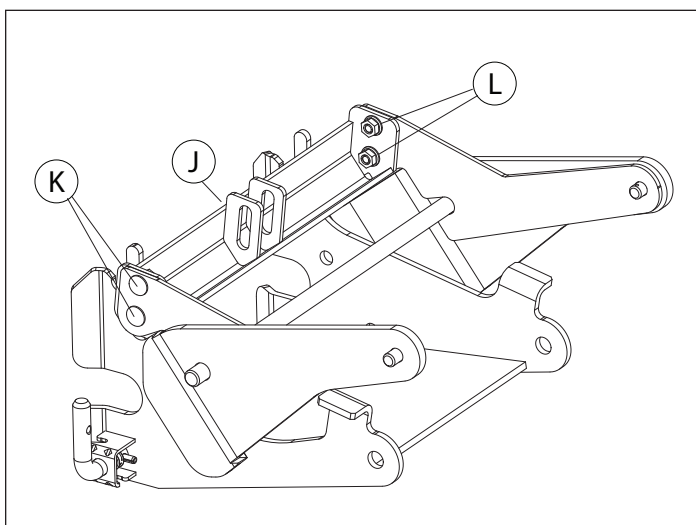

Equipment

44" Blade only:

5. Place the Blade Lift Bracket (M) on top of the blade frame in the center, 6" from the rear flat edge and mark the location of the two holes (N).
6. Drill two 3/8" holes in the frame and mount the bracket using two 3/8" x 1" Flange Bolts and 3/8" Flange Nuts.

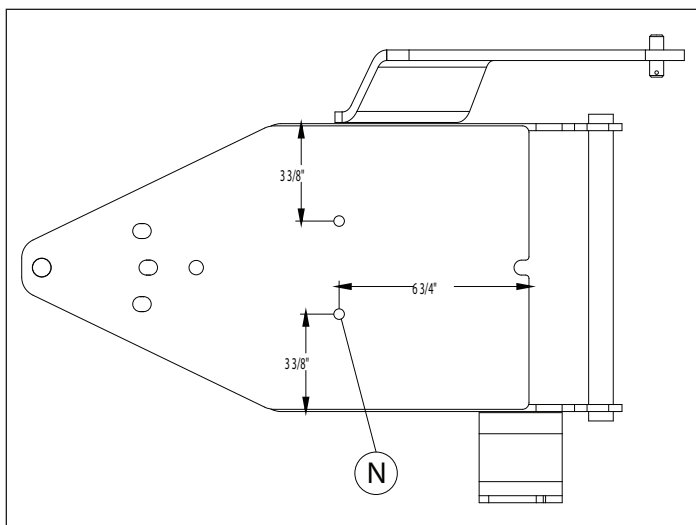
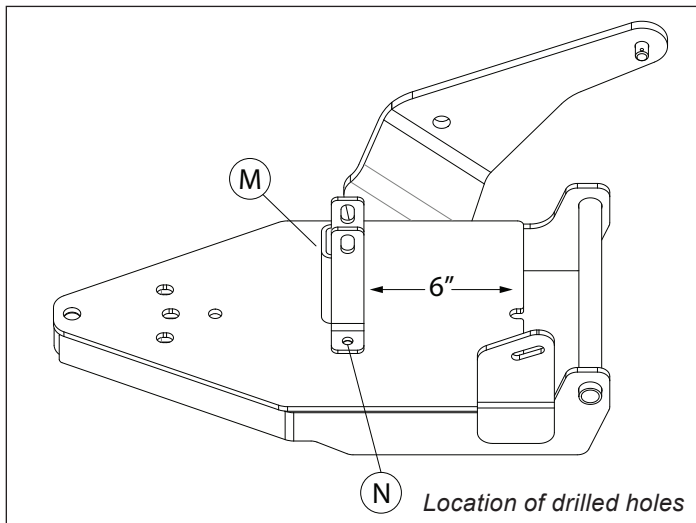

7. Mount Snow Blower Hitch or Blade onto tractor.
8. Connect Actuator (O) to the Lift Frame using a 1/2" x 2-1/4" Clevis Pin (P) and small bow-tie clip.
9. To install the lower pin (Q) using the same hardware, either lift the frame to align the actuator hole or extend the actuator until the holes align.

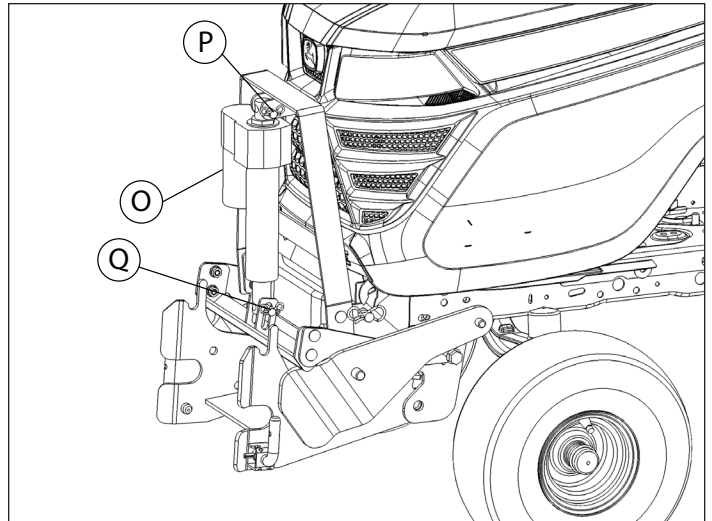

To open Tractor Hood

1. Lower blade or snow blower to the ground with the lower pin (A) on the actuator floating free in the slot. Unplug actuator.
2. Remove lower pin of actuator and mounting shaft (B). Slide lift frame (with actuator attached) forward and lift up. Hood can now be opened.

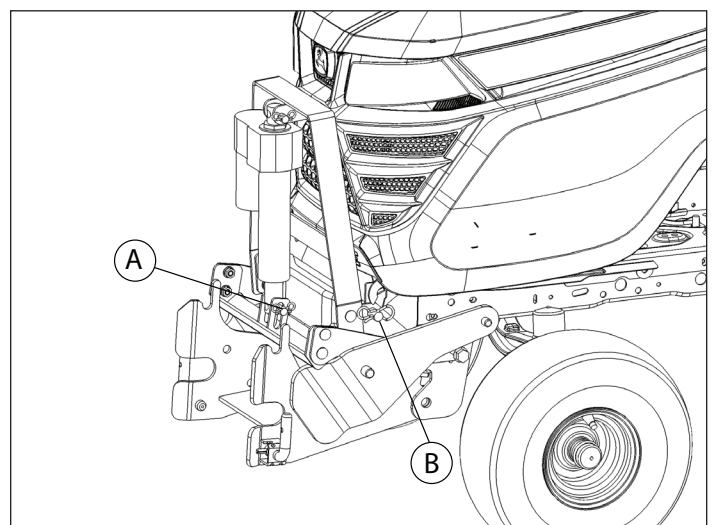

Removal

Same as hood opening above. Wiring can remain in place under hood, lift brackets can stay on snow blower hitch or blade frame.

Warranty

John Deere Quality Continues with Quality Service

John Deere provides a process to handle your questions or problems, should they arise, to ensure that product quality continues with quality parts and service support.

Follow the steps below to get answers to any questions you may have about your product.

1. Refer to your attachment and machine operator manuals.
2. In North America or Canada, call Agri-Fab Customer Service at 1-800-448-9282 and provide product serial number (if available) and model number.

Warranty:

Limited Warranty for New John Deere Licensed Products

Agri-Fab's attachments are guaranteed to be free from defects in material and workmanship from the date of purchase for 2 years residential use, 6 months commercial use, provided that the purchaser properly assembles, installs, uses and maintains the products in accordance with this manual.

Purchaser's failure to adhere to such requirements will void the warranty. To the extent permitted by applicable law, all other warranties, representations, obligations and conditions, expressed or implied, including but not limited to implied warranties of merchantability, fitness for any particular purpose and non-infringement, are hereby disclaimed and excluded.

Any product which does not meet warranty shall, as purchaser's sole and exclusive remedy, be repaired or replaced by Agri-Fab. This warranty is non transferable.

In addition, our warranty does not cover:

- Labor charges
- Loss or consequential, incidental or special damages of any kind
- Electric actuators are warranted for one year

This page intentionally left blank