

INSTALLATION INSTRUCTIONS

Click-N-Go Hitch & Display for Fertilizer Spreader (ST70015)



Parts in Kit

Description	Qty
Click-N-Go Hitch	1
Fabric Shield	1
1/4" x 5/8" SS hex bolts	4
1/4" SS nylock nuts	4
User Interface (Display) w/ mounting hardware	1
Display Mounting Bracket	1
Display Bracket Receiver	1
Display Cable	1
X700 Power Harness	1
Grommet 1/2" ID x 3/4" OD	1
5/16" x 1/2" Truss Head Bolt	2
5/16" Flange Nut	2
Dielectric Grease Packet 4 grams	1
Wire Tie 6"	5

Assembly

1. Connect the Click-N-Go hitch (A) to the spreader using four 1/2 in. x 1-1/2 in. flange bolts (B)

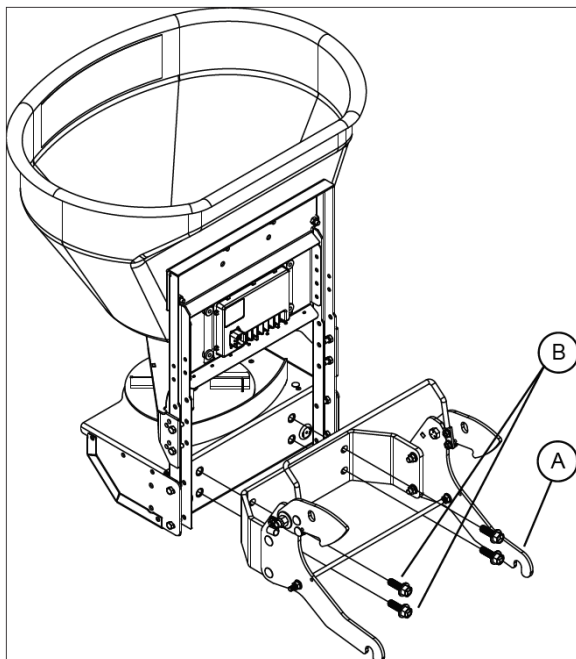

2. Route spreader harness down the frame alongside the motor harness then under the release bar on the hitch and secure to square hole in hitch mount with wire tie.

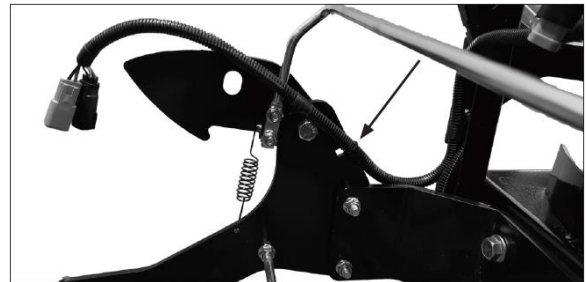

3. Attach spreader shield to spreader using four 1/4 in. x 5/8 in. hex bolts (C) and four 1/4 in. nylock nuts (D)

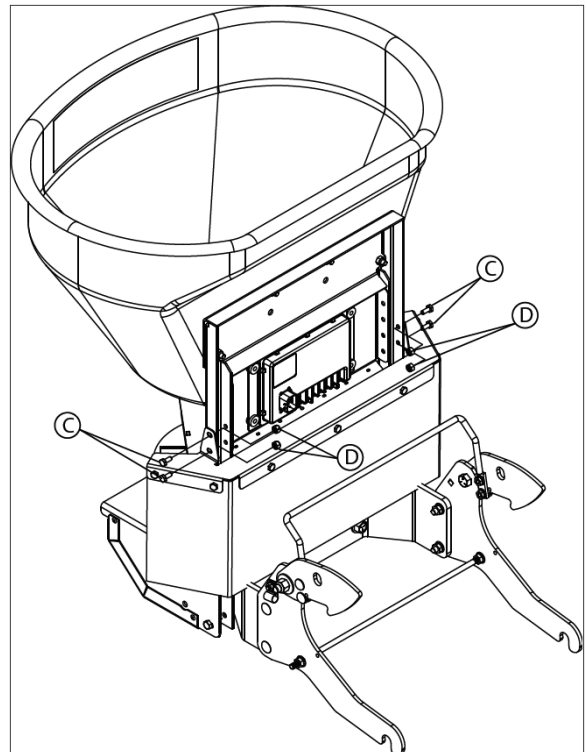

Installation

Prepare Machine

Install Ballast

If no front attachment is installed on tractor, ballast is required to stabilize machine. X700 Series tractors require four front suitcase weights, 18Kg (40 lbs) each.

Install Display and Wiring

1. Remove the toolbox by removing two (2) M10 Nuts (A) from the toolbox and two (2) M13 Nuts from the handle. Disconnect the vehicle wire harness from the 12V Aux outlet.

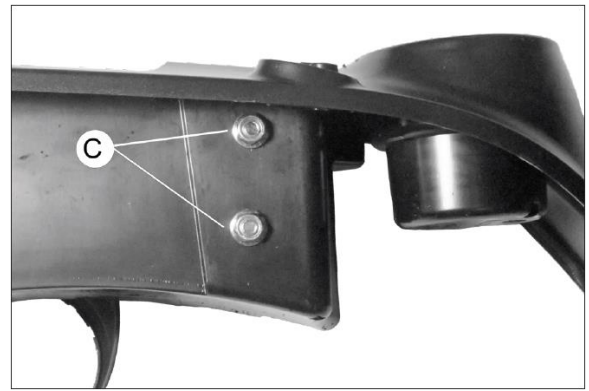

2. Locate the left support rib on the underside of the toolbox flange. Mark the top hole 3/8 in. to the right and 3/8 in. down. The bottom hole is 1-3/4 in. below the top hole. Drill a 7/16 in. hole at both locations.

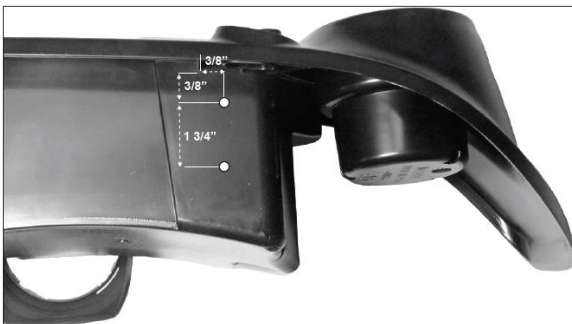

3. Install the spade mount on the inside of the toolbox using two 5/16 in. truss head screws (B) and two 5/16 in. flange nuts (C).

NOTE: Orient the mount with the wider opening facing up.

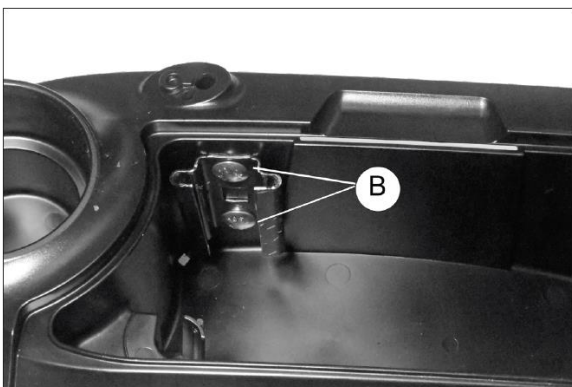

4. Starting at the lower right corner on the rear of the toolbox, measure up 1/2 in. to 3/4 in. and left 1/2 in. to 3/4 in. and drill a 3/4 in. hole.



5. Install grommet over circular connector on the power harness (D) and feed harness through the hole in the rear of the toolbox seating the grommet in the hole.

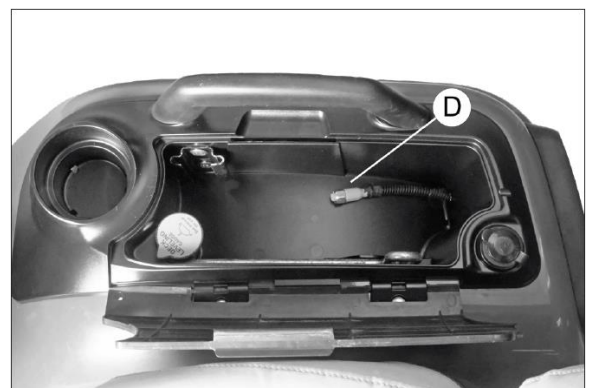

6. Install the power harness (E) in between the vehicle wire harness (F) and 12V Aux outlet (G). Ensure that the connectors are fully seated.

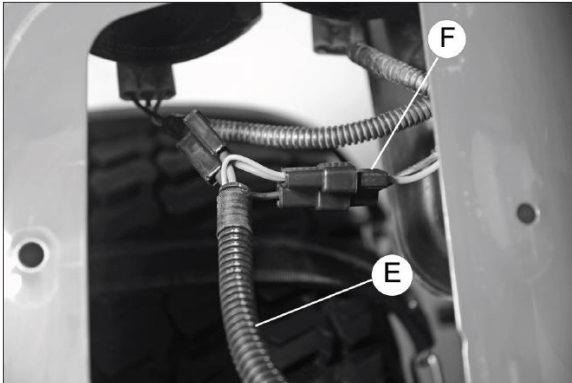

7. Reinstall the toolbox and tighten the M10 nuts on toolbox and the M13 nuts on the handle. Route the two connectors on the free end of the power harness through the elliptical hole in the frame (H) and secure with a wire tie through a nearby hole. Remove any slack in the harness by pulling on the circular connector in the toolbox.

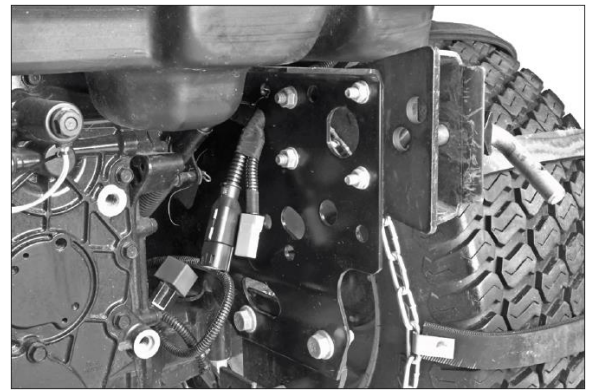
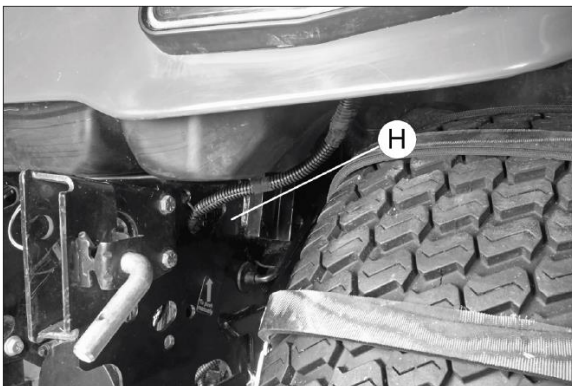

8. Attach the display cable (J) to the connector on the rear of the display (K).

NOTE: Hand tighten the connector coupling nut to 0.5-1.0 ft-lb. Be careful not to cross thread the nut on the plastic threads. Do not twist the over molded portion of the connector, only twist the metal coupling nut or damage may occur to the display connector pins.

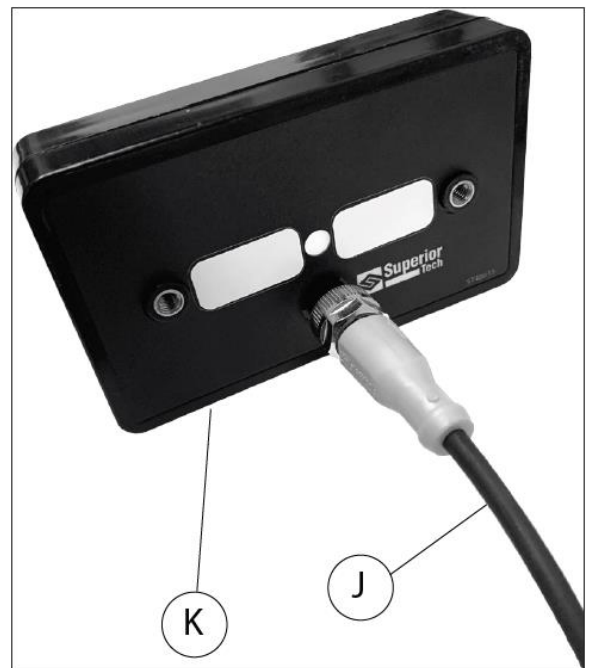

- Install the Display (L) to the Mounting Bracket (M) using two M5 x 8mm screws (N) and two M5 washers (P).

NOTE: Tighten the screws to 4-5 ft-lb. Do not over tighten or damage may occur to the threaded inserts and plastic housing.

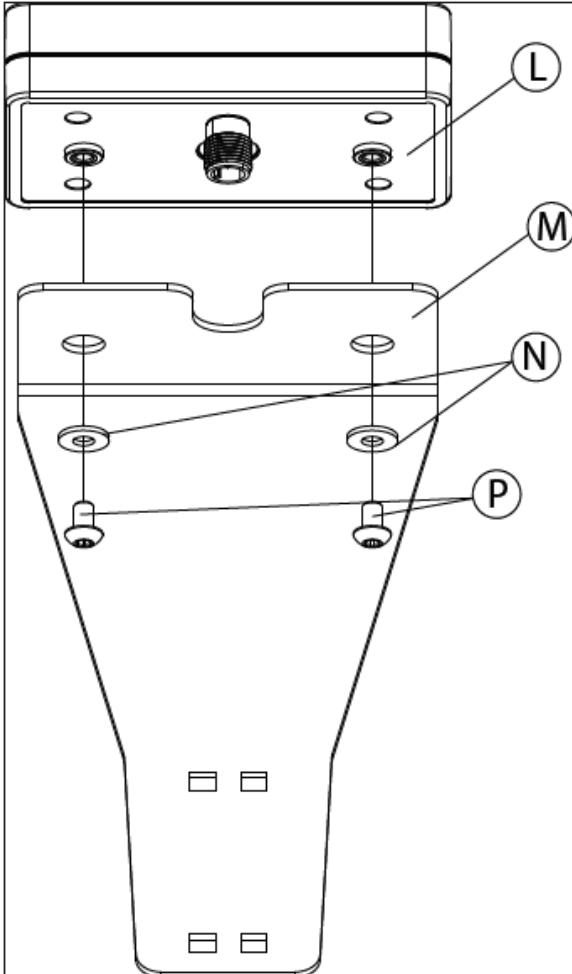

- Secure the Display Harness to the Mounting Bracket with a wire tie through the holes on either side of the harness.



- Mount the Display by sliding the Mounting Bracket into the toolbox mount and pressing down firmly. Attach the display harness (Q) to the power harness (R).

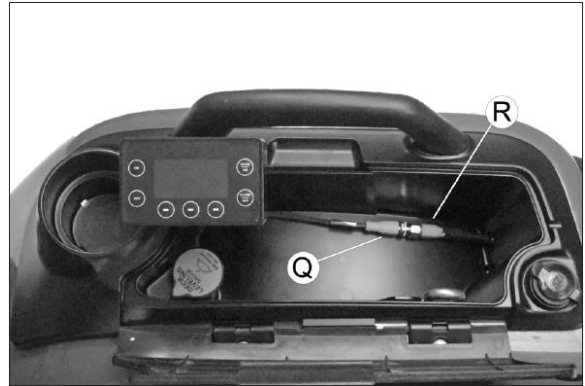

Install Spreader

NOTE: It is recommended that two people lift the spreader for this installation.

- With pins (A) locked out, lean spreader back and place lower mount slots over studs (B).
- Lift the rear of the spreader until it clicks into position. Release pins (A) verify full pin engagement for proper securement.

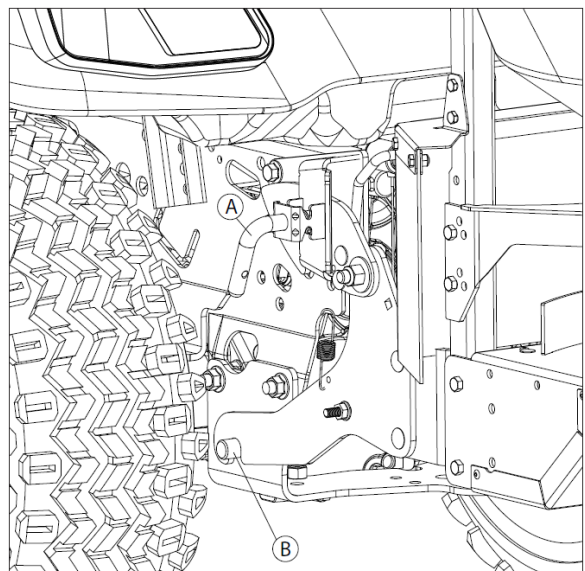

3. Connect Spreader Harness (C) to Power Harness (D).

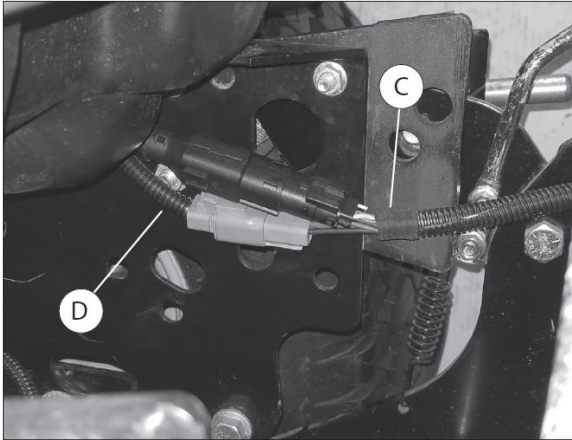

Removal and Storage

Removing Spreader

1. Disconnect the Spreader Harness from the Power Harness.
2. Move the upper pins (A) to the locked-out position.
3. Lift the spreader slightly and pull back on the release bar (B) and lower the spreader to the ground.
4. Disengage lower mount slots (C) and slide spreader away from vehicle.

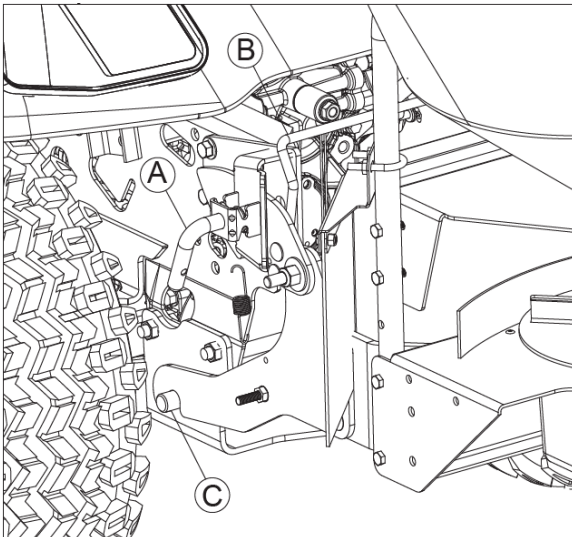

Remove Display

1. Disconnect Display Harness (A) from Power Harness (B).

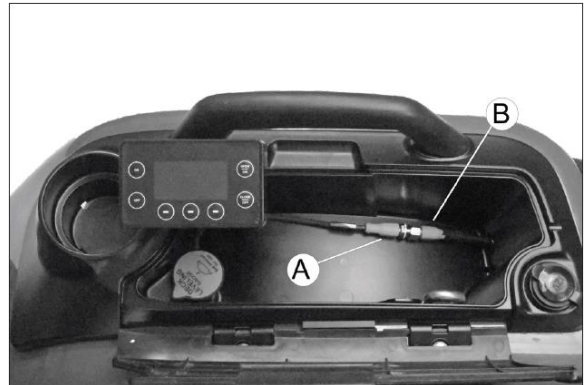

2. Remove display by sliding bracket out of mount inside toolbox.
3. Store display in dry location.

Storage

1. Wash spreader and allow to dry.
2. Apply dielectric grease on all electrical connections to prevent corrosion.
3. Cover spreader and store.