



JOHN DEERE

INSTALLATION INSTRUCTIONS

44in Plow Angling Kit

LP33712
Supplier ST50905
04/25/2022
ENGLISH

Introduction

Using Your Operator's Manual

Read this entire operator's manual, especially the safety information, before operating.

This manual is an important part of your machine. Keep all manuals in a convenient location so they can be accessed easily.

Use the safety and operating information in the attachment operator's manual, along with the machine operator's manual, to operate and service the attachment safely and correctly.

If your attachment manual has a section titled Preparing the Machine, it means that you will have to do something to your tractor or vehicle before you can install the attachment. The Assembly and Installation sections of this manual provide information to assemble and install the attachment to your tractor or vehicle. Use the Service section to make any needed adjustments and routine service to your attachment.

If you have any questions or concerns with the assembly, installation, or operation of this attachment, see your local John Deere dealer or call Agri-Fab at 1-800-448-9282 for assistance.

Warranty information for this John Deere attachment can be found in the warranty statement included in this manual.

Table of Contents

Introduction	2
Product Compatibility	2
Safety Labels	3
Safety	4-5
Assembly	6
Installation	7
Template	9
Good Quality Service.....	11
Warranty	12

Product Compatibility

This kit is compatible with all X300 Series and X500 Series Multi-Terrain tractors with the 44 in. front blade.

Original instructions. All information, illustrations and specifications in this manual are based on the latest information available at the time of publication.

The right is reserved to make changes at any time without notice.

NOTE: Retain these installation instructions with the machine operators manual.

Safety Labels

Safety Label Locations

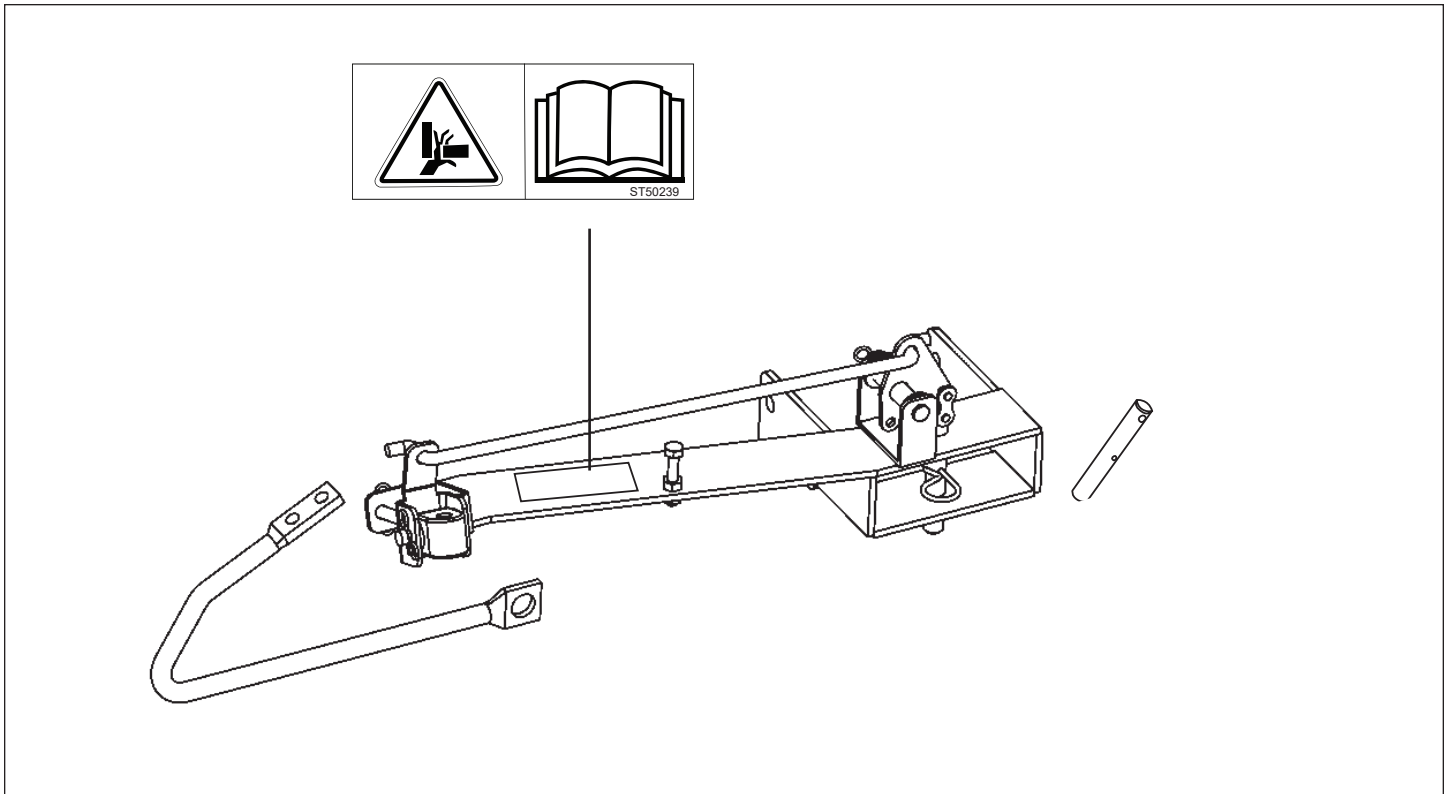

Understanding The Machine Safety Labels



The machine safety labels shown in this section are placed in important areas on your machine to draw attention to potential safety hazards. DANGER or WARNING safety labels are located near specific hazards.

The operator's manual also explains any potential safety hazards whenever necessary in special safety messages that are identified with the word, CAUTION, and the safety-alert symbol.

- CAUTION; The signal word CAUTION indicates a hazardous situation which, if not avoided, could result in minor or moderate injury. CAUTION may also be used to alert against practices associated with events which could lead to personal injury.

Replace missing or damaged safety labels. Use this operator's manual for correct safety label placement.

There can be more safety information contained on parts and components sourced from suppliers that is not reproduced in this operator's manual.

French or Spanish Safety Labels and Operator's Manual

Operator's manuals and safety labels with content in French or Spanish are available for this machine through authorized John Deere dealers. See your John Deere dealer.

NOTE: Both text and no-text labels are shown. Your machine is only equipped with one of these types of labels.

CAUTION

AVOID INJURY AND READ OPERATOR MANUAL BEFORE USE

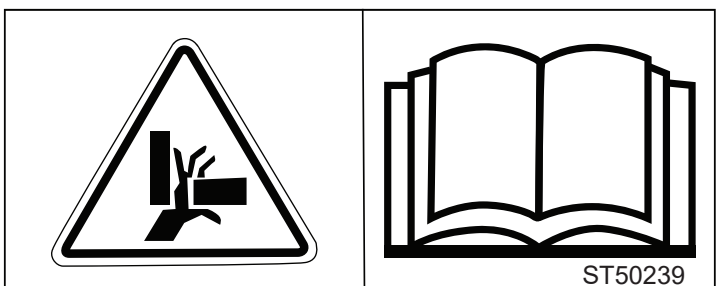

Safety

Read Safety in Machine Operator's Manual

Read the general safety operating precautions in your machine operator's manual.

Operating Safety

- Read the machine and attachment operator's manual carefully. Be thoroughly familiar with the controls and the proper use of the equipment. Know how to stop the machine and disengage the controls quickly.
- This attachment is intended for use in property maintenance applications. Do not use for use other than intended by the manufacturer. Do not modify machine or safety devices. Unauthorized modifications to the machine or attachment may impair its function and safety.
- Do not let children or an untrained person operate machine.
- Make any necessary adjustments before you operate. Never attempt to make any adjustments while the engine is running, unless it is recommended in adjustment procedure.
- Look behind machine before you back up. Back up carefully.
- Never carry passengers, especially children, on machine or attachment. Riders are subject to injury such as being struck by foreign objects and being thrown off. Riders may also obstruct the operator's view, resulting in the machine being operated in an unsafe manner.
- Weight of mounted machines, including their loads, can influence vehicle maneuverability. Refer to vehicle OM for ballasting.

Practice Safe Maintenance

- Only qualified, trained adults should service this machine.
- Understand service procedure before doing work. Keep area clean and dry.
- Do not operate the engine in a confined space where dangerous carbon monoxide fumes can collect.
- Never lubricate, service or adjust the machine or attachment while it is moving. Keep safety devices in place and in working condition. Keep hardware tight.
- Keep hands, feet, clothing, jewelry, and long hair away from any moving parts, to prevent them from getting caught.

- Lower any attachment completely to the ground or to an existing attachment mechanical stop before servicing the attachment. Disengage all power and stop the engine. Lock park brake and remove the key. Let machine cool.
- Disconnect the negative battery cable(s) before making any repairs.
- Before servicing machine or attachment, carefully release pressure from any components with stored energy, such as hydraulic components and springs.
- Release hydraulic pressure by lowering attachment or cutting units to the ground or to a mechanical stop and move hydraulic control levers.
- Securely support any machine or attachment elements that must be raised for service work. Use jack stands or lock service latches to support components when needed.
- Never run engine unless park brake is locked.
- Keep all parts in good condition and properly installed. Fix damage immediately. Replace worn or broken parts. Replace all worn or damaged safety and instruction decals.
- Check all hardware at frequent intervals to be sure the equipment is in safe working condition.
- Do not modify machine or safety devices. Unauthorized modifications to the machine or attachment may impair its function and safety.

Parking Safely

1. Stop vehicle on a level surface, not a slope.
2. Fully lower the cargo box and any attachments on the machine that can be lowered.
3. Fully engage parking brake and ensure vehicle is not moving.
4. Stop engine.
5. Remove key.
6. Before you leave the operator's seat, wait for the engine and all moving parts to stop.
7. Disconnect the negative battery cable before servicing the machine.

Safety

Wear Appropriate Clothing

- Always wear eye protection when operating the machine.
- Wear close fitting clothing and safety equipment appropriate for the job.
- While operating this machine, always wear substantial footwear and long trousers. Do not operate the equipment when barefoot or wearing open sandals.
- Wear a suitable protective device such as earplugs. Loud noise can cause impairment or loss of hearing.
- Always wear substantial footwear. Do not operate the equipment when barefoot or wearing open sandals.

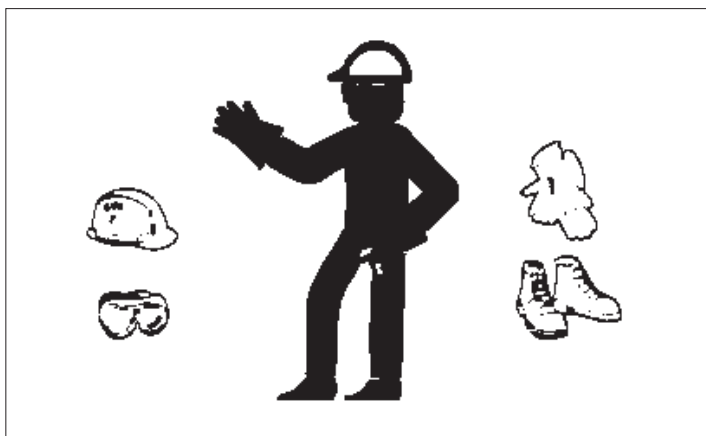

Read Chemical Container Label

- Chemicals can be dangerous. Improper selection or use can injure persons, animals, plants, soils or other property. Select the right chemical for the job and handle and apply with care.
- Read the instructions, precautions, and warnings on the container label before opening. Use the product strictly according to label directions for specific applications, in the amounts specified, at the times specified and only when needed.
- Do not remove labels from chemical containers. Store all chemicals in their original containers.
- Do not mix chemicals unless stated on the container label.
- Store chemicals when not in use according to the container label.

Handle Chemical Products Safely

- Direct exposure to hazardous chemicals can cause serious injury. Potentially hazardous chemicals used with John Deere equipment include pesticides, herbicides and fungicides.

- A Material Safety Data Sheet (MSDS) provides specific details on chemical products: physical and health hazards, safety procedures, and emergency response techniques.
- The MSDS should be obtained from the chemical dealer at the time of the chemical purchase.
- Check the MSDS before beginning any job using a hazardous chemical. Know exactly what the risks are and how to do the job safely. Always wear recommended personal protection equipment.

Handling Waste Product and Chemicals

- Waste products, such as used oil, fuel, coolant, brake fluid, and batteries, can harm the environment and people.
- Do not use beverage containers for waste fluids - someone may drink from them.
- See your local Recycling Center or authorized dealer to learn how to recycle or get rid of waste products.
- A Material Safety Data Sheet (MSDS) provides specific details on chemical products: physical and health hazards, safety procedures, and emergency response techniques. The seller of the chemical products used with your machine is responsible for providing the MSDS for that product.

Assembly

Parts in Kit

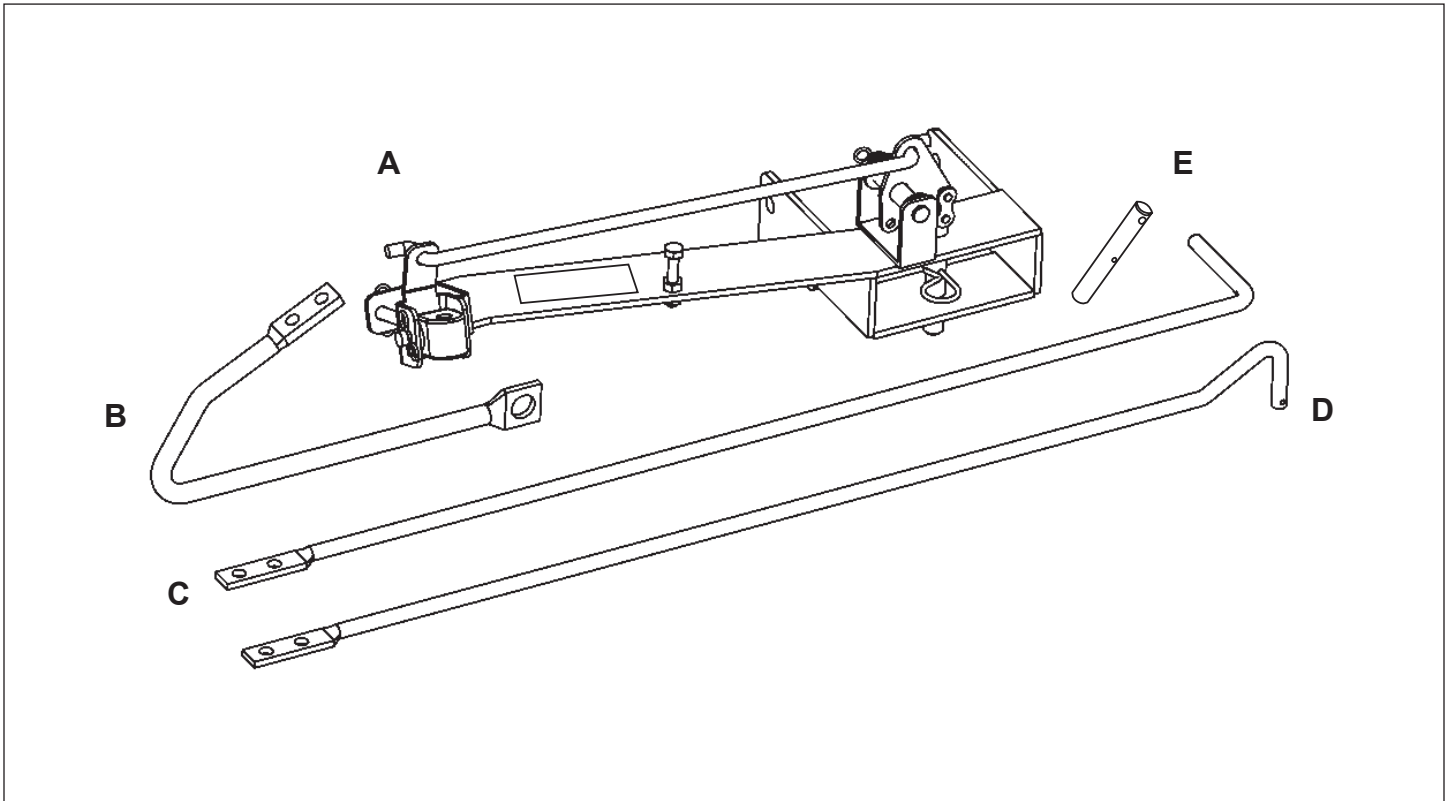

Angling parts

Parts Description	Letter	Qty
Angling Assembly	A	1
Lever Bracket	B	1
Lever Top	C	1
Lever Bottom	D	1

Spare Parts Bag

Parts Description	Letter	Qty
Pin	E	1

Hardware Bag

Parts Description	Qty
Bolt, 3/8 x 5-1/2 in.	2
Nut, 3/8 in.	2
Bolt, 5/16 x 3/4 in.	2
Carriage Bolt, 5/16 x 3/4 in.	2
Nut, 5/16 in.	4
Bolt, 1/2 x 1 in.	1
Locknut, 1/2 in.	1
Spring Clip	1
Spring	1

Installation

Installing Blade Angling Components

NOTE: For blades manufactured prior to 2011, it is necessary to drill three holes in the blade's lift frame. Use 13.5 mm (17/32 in.) drill bit. Cut out and use drilling template on the last page.

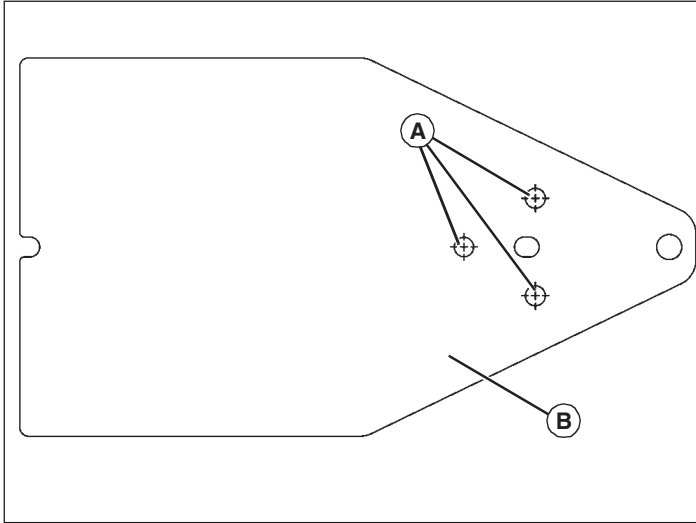

1. If blade is manufactured before 2011, drill three 13.5 mm (17/32 in.) holes (A) in blade lift frame (B). Cut out and use the template on the last page for drilling location. See last page of instruction for drilling template.
- After drilling holes, clean metal particles from the top of the lift frame and apply grease on the surfaces between the lift frame and the blade before reassembling.

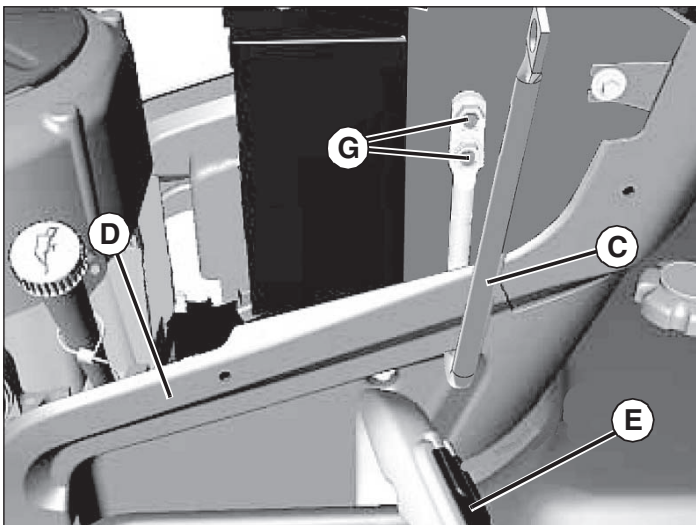

2. Install end of lever bracket (C) through an existing hole in the removable console panel (D), inside the lift pedal (E), at the left side of the machine.

3. Align the two mounting holes in the lever bracket with two square holes in the left side console support plate (F). Fasten with 5/16 x 3/4 in. carriage bolts (G) and 5/16 in. nuts.

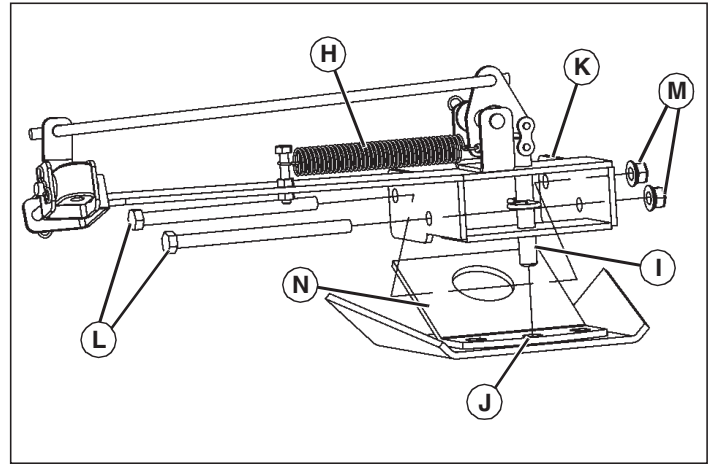

4. Install the spring (H) as shown.

NOTE: The front bolt (L) goes under the angled plate (N) on the blade, and the rear bolt is on top. Make sure pin (I) moves freely before tightening hardware.

5. Align the pin (I) with the center hole (J) in the blade, and place the angling assembly (K) on top of the blade. Fasten with two 3/8 x 5-1/2 in. bolts (L) and 3/8 in. flange nuts (M).

Note: Pin (I) is a serviceable item. An extra is provided with hardware bag.

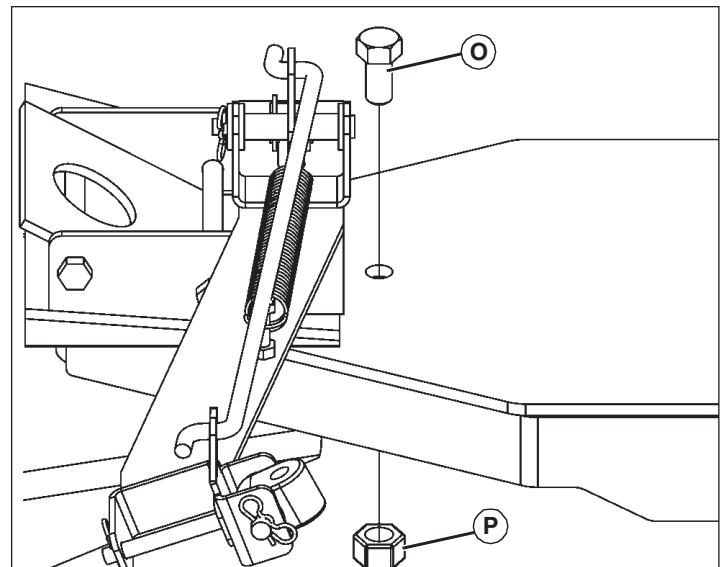

6. Install 1/2 x 1 in. bolt (O) through hole and secure with 1/2 in. locknut (P).

Installation

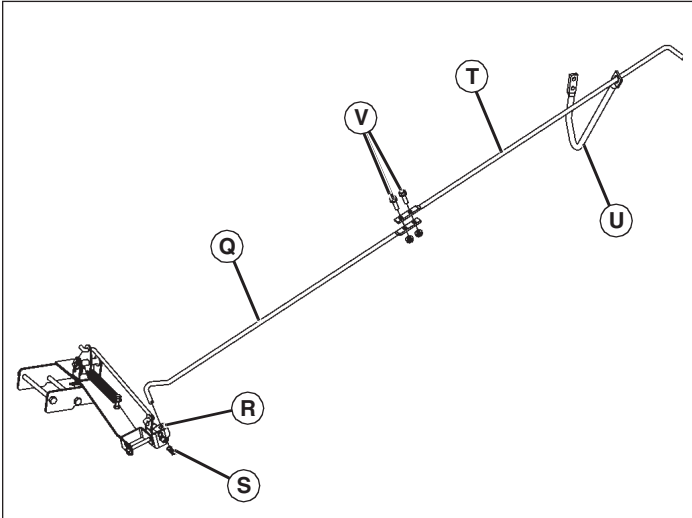

7. Install lever bottom (Q) downwards through the hole in the plastic block (R) and fasten with spring clip (S).
8. Install lever top (T) through the hole in the lever bracket (U). With the lever top facing away from the tractor, fasten to lever bottom using two 5/16 x 3/4 in. bolts (V) and 5/16 in. nuts.

Template

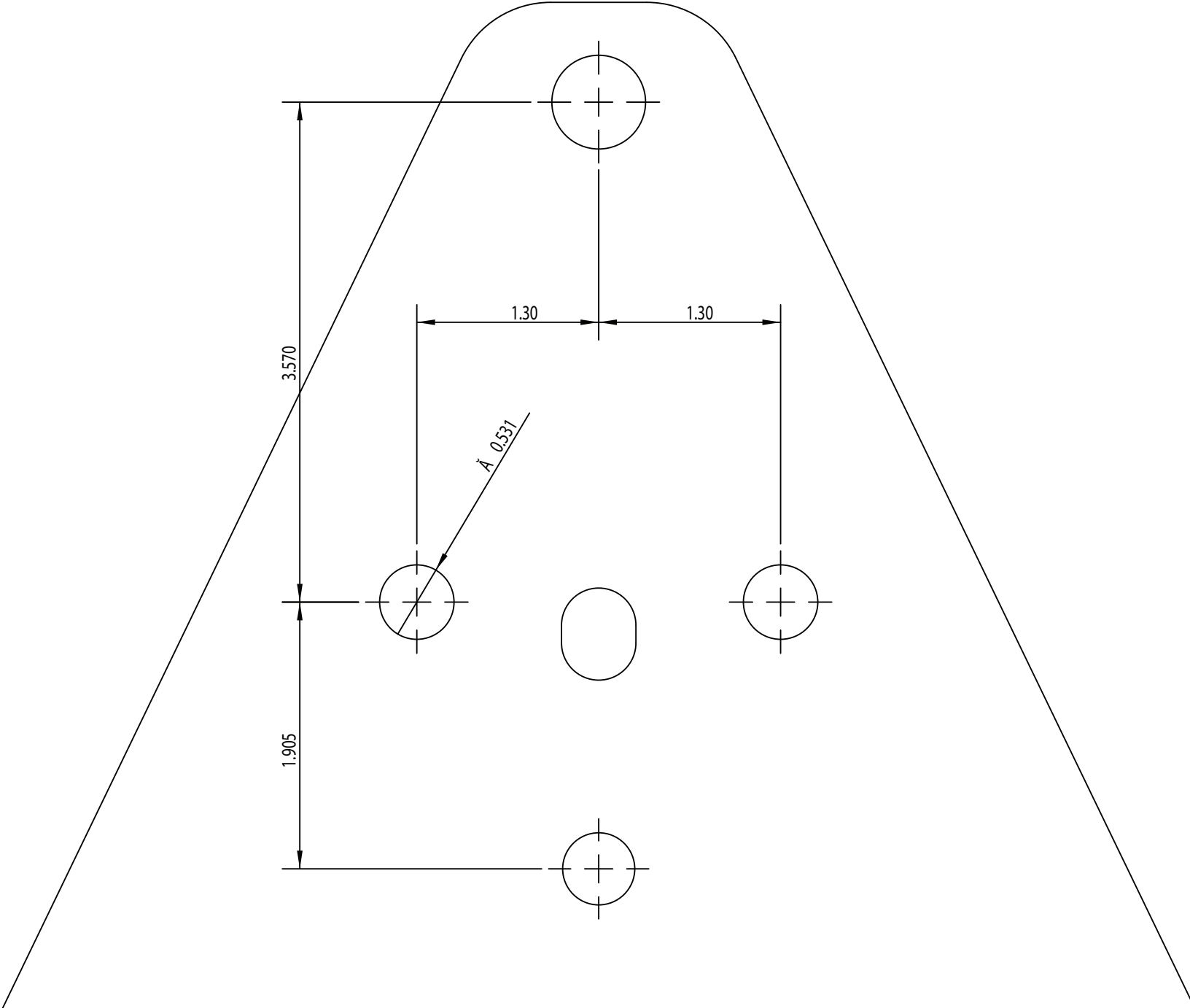

This page intentionally left blank

Good Quality Service

John Deere Quality Continues with Quality Service

John Deere provides a process to handle your questions or problems, should they arise, to ensure that product quality continues with quality parts and service support.

Follow the steps below to get answers to any questions you may have about your product.

Refer to your attachment and machine operator manuals.

In North America or Canada, call Agri-Fab 1-800-448-9282 and provide product serial number (if available) and model number.

Warranty

Limited Warranty for New John Deere Licensed Products

Agri-Fab spreaders are guaranteed to be free from defects in material and workmanship from the date of purchase for 1 year residential use, 6 months commercial use, provided that the purchaser properly assembles, installs, uses and maintains the products in accordance with this manual.

Purchaser's failure to adhere to such requirements will void the warranty. To the extent permitted by applicable law, all other warranties, representations, obligations and conditions, expressed or implied, including but not limited to implied warranties of merchantability, fitness for any particular purpose and non-infringement, are hereby disclaimed and excluded.

Any product which does not meet warranty shall, as purchaser's sole and exclusive remedy, be repaired or replaced by Agri-Fab. This warranty is non-transferable.

In addition, our warranty does not cover:

- Labor charges
- Loss or consequential, incidental or special damages of any kind.

This product was manufactured by Agri-Fab a John Deere Licensee, located at 809 S Hamilton St Sullivan, IL 61951.. If you have any questions or concerns with the assembly, installation, or operation of this attachment, see your local John Deere dealer or call Agri-Fab at 1-800-448-9282 for assistance.

